

SUGGESTED PCB LAYOUT

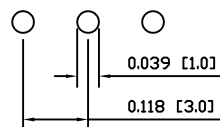

SCHEMATIC

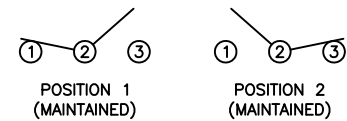

SPECIFICATIONS

FUNCTION:
1P2T ON-ONRATINGS:
0.5A 50VDCCONTACT RESISTANCE:
Initial: 30mΩ Max.INSULATION RESISTANCE:
500MΩ Min. at 500VDCDIELECTRIC STRENGTH:
500VAC For 1 MinuteELECTRICAL LIFE:
10,000 Cycles

APPROVALS:

RoHS LEAD FREE
COMPLIANT PROCESS COMPATIBLE

MATERIALS

BASE:
Phenolic BoardCOVER:
Nickel Plated SteelACTUATOR:
Polyoxymethylene (POM)CONTACT:
Gold (0.03μm) over
Nickel (2μm) Plated
BrassTERMINALS:
Gold (0.03μm) over
Nickel (2μm) Plated
Brass

COLORS

ACTUATOR:
Black

E-SWITCH®



LSS-120312B5-G

THE INFORMATION CONTAINED IN THIS DOCUMENT IS PROPRIETARY TO E-SWITCH AND IS
NOT TO BE COPIED OR TRANSFERREDA
REV.INITIAL RELEASE
DESCRIPTIONPCRD0081
PCR09/08/19
DATECAB
DRAWN BYDIMENSIONS
INCHES [MILLIMETERS]
GENERAL TOLERANCES
±0.008 [±0.2] / ±1°SCALE
DRAWING NOT TO SCALEPROJECTION
FIRST ANGLEDRAWING NUMBER
03-LSS120312B5GDATE
AUGUST 19, 2009REVISION
A