

SCHEMATIC

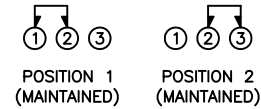

SPECIFICATIONS

FUNCTION:
1P2T ON-ON

RATINGS:
0.5A 50VDC

OPERATING FORCE:
250±100gf

CONTACT RESISTANCE:
Initial: 30mΩ Max.

INSULATION RESISTANCE:
500MΩ Min. at 500VDC

DIELECTRIC STRENGTH:
500VAC For 1 Minute

ELECTRICAL LIFE:
10,000 Cycles

TEMPERATURE:
Operating: -10°C to 60°C

APPROVALS:

RoHS LEAD FREE
COMPLIANT PROCESS COMPATIBLE

MATERIALS

UPPER BODY:
Tin Plated Cold Rolled Steel (SPCC-SD)

LOWER BODY:
Phenolic Board (SD-102C), UL94 HB

ACTUATOR:
Polyoxymethylene (POM)
(TYSTRON POM7520), UL94 HB

CONTACT:
Silver Plated Phosphor Bronze (C5210R)

TERMINALS:
Silver Plated Brass (C2680R)

TERMINALS:
Silver Plated Brass (C2680R)

COLORS

BODY:
Metallic

ACTUATOR:
Black

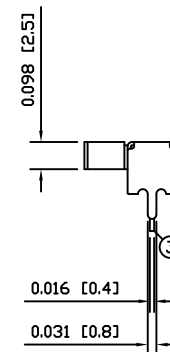
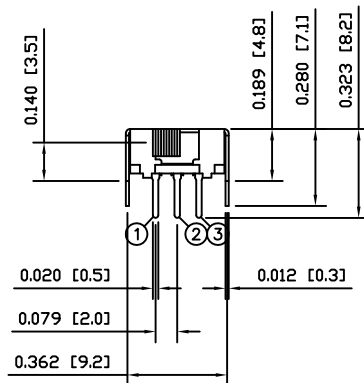
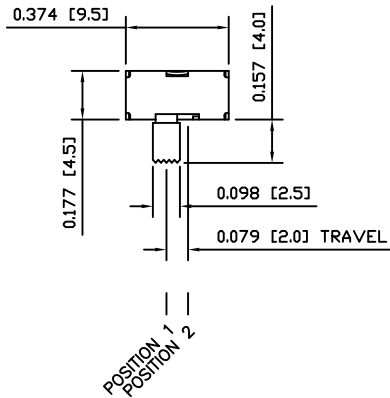

SUGGESTED PCB LAYOUT

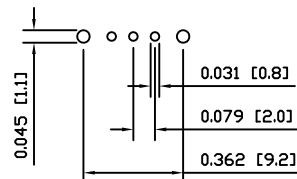

E-SWITCH®



SK-12D04-G(A)4-S

THE INFORMATION CONTAINED IN THIS DOCUMENT IS PROPRIETARY TO E-SWITCH AND IS
NOT TO BE COPIED OR TRANSFERRED

A
REV.

INITIAL RELEASE
DESCRIPTION

19596
PCR

11/01/19
DATE

CAB
DRAWN BY

DIMENSIONS
INCHES [MILLIMETERS]
GENERAL TOLERANCES
±0.008 [±0.2] / ±1°

SCALE
DRAWING NOT TO SCALE

PROJECTION
FIRST ANGLE

ITEM NUMBER
03-SK12D04GA4S

DATE
JANUARY 19, 2011

REVISION
A