

MATERIAL NUMBER	ENGINEERING NUMBER	MOUNTING OPTION	CKT SIZE	DIM A	DIM B	DIM C	DIM D
46999-0096	5559-04P2-225	W/EARS	4	.709	.496	.724	.921
26-01-3093	5559-04P3-225	NO EARS		(18.00)	(12.60)	(18.40)	(23.40)
NOT TOOLED	5559-05P2-225	W/EARS	5	.874	.661	.890	1.087
50-36-1681	5559-05P3-225	NO EARS		(22.20)	(16.80)	(22.60)	(27.60)

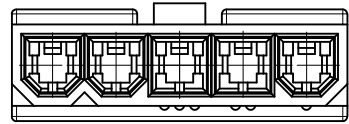

5 CKT WITHOUT MOUNTING EARS SHOWN

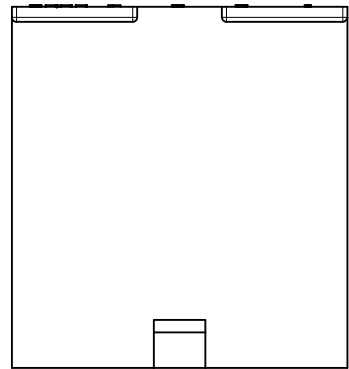
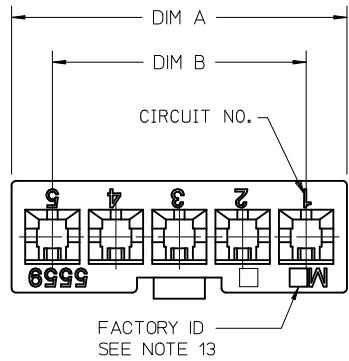
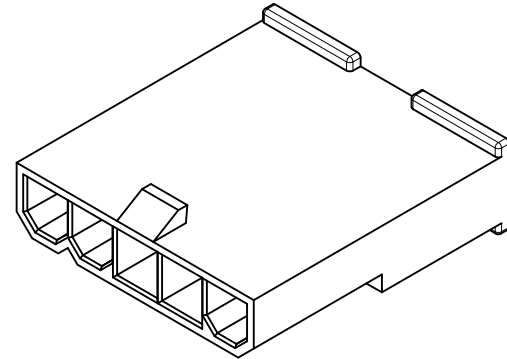
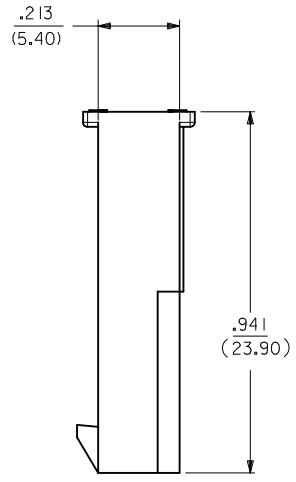

LEGEND

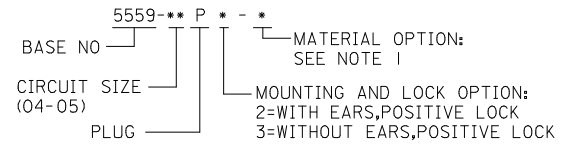

- NOTES:
- MATERIAL:
"225" = NYLON (PA6), UL94V-0, COLOR: BLACK; IEC 60335-1, 4th EDITION GLOW WIRE CAPABLE.
 - FINISH: NOT APPLICABLE
 - PRODUCT SPECIFICATION: PS-5556-001
 - PACKAGING: BULK PER PK-5559-003
 - PART MATES WITH MOLEX RECEPTACLE #5557.
 - PART TO BE USED WITH MOLEX MALE TERMINAL #5558.
 - PART IS NOT DESIGNED FOR CURRENT SHARING.
 - CONNECTORS ARE NOT TO BE MATED OR UNMATED WHILE CIRCUITS ARE LIVE.
 - WIRES ARE TO BE DRESSED IN SUCH A MANNER TO ALLOW THE TERMINALS TO FLOAT FREELY IN THE POCKET.
 - PANEL MOUNT VERSION IS FOR USE WITH .031-.079/(0.80/2.00) THICK PANELS.
 - PANEL SHOULD BE PUNCHED IN THE DIRECTION OF CONNECTOR INSERTION.
 - PART CONFORMS TO CLASS "B" REQUIREMENTS OF COSMETIC SPECIFICATION PS-45499-002 WITH THE EXCEPTION OF DISCOLORATION, FLASH AND SINK MEET CLASS "C" REQUIREMENTS.
 - FACTORY ID MAY BE LOCATED ON EARS.

RELEASE -04P2-225 IEC NO: UCP2011-3562 DRWINANGUYEN 2011/05/18 CHKD:JBELL 2011/05/18 APPR:FSMITH 2011/08/05	QUALITY SYMBOLS 	GENERAL TOLERANCES (UNLESS SPECIFIED)		DIMENSION STYLE IN/MM		SCALE 4:1	DESIGN UNITS METRIC	THIRD ANGLE PROJECTION	
		mm	INCH	DRAWN BY LSCHMIDT	DATE 2007/07/02	TITLE MINI-FIT JR. SERIES PLUG SINGLE ROW (GLOW WIRE)			
		4 PLACES ± .010	± .010	CHECKED BY ADERR	DATE 2007/07/03				
		3 PLACES ± .010	± .010	APPROVED BY FSMITH		DATE 2011/03/10	MOLEX INCORPORATED DOCUMENT NO. SD-5559-525		
2 PLACES ± 0.25	± .015	MATERIAL NO. SEE CHART		SHEET NO. 1 OF 2		THIS DRAWING CONTAINS INFORMATION THAT IS PROPRIETARY TO MOLEX INCORPORATED AND SHOULD NOT BE USED WITHOUT WRITTEN PERMISSION			
1 PLACE ± 0.38	± .010	DRAFT WHERE APPLICABLE MUST REMAIN WITHIN DIMENSIONS							

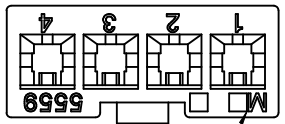

FACTORY ID
SEE NOTE 13

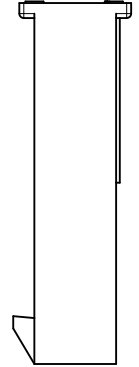
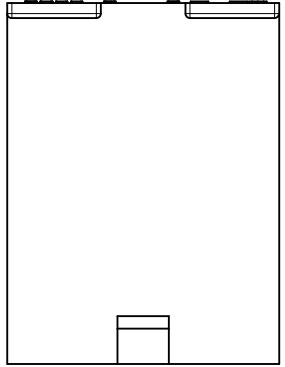

SEE NOTE 13

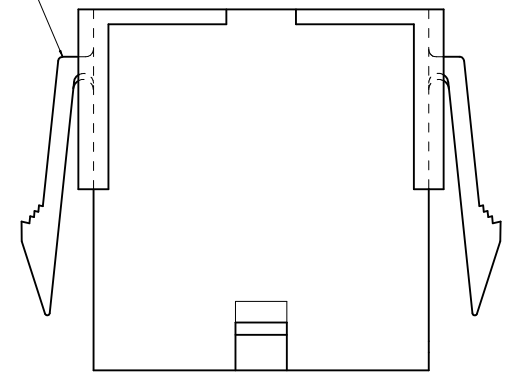

WITH MOUNTING EARS

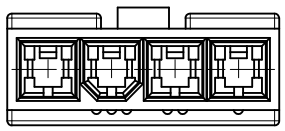

4 CKT WITHOUT
MOUNTING EARS SHOWN

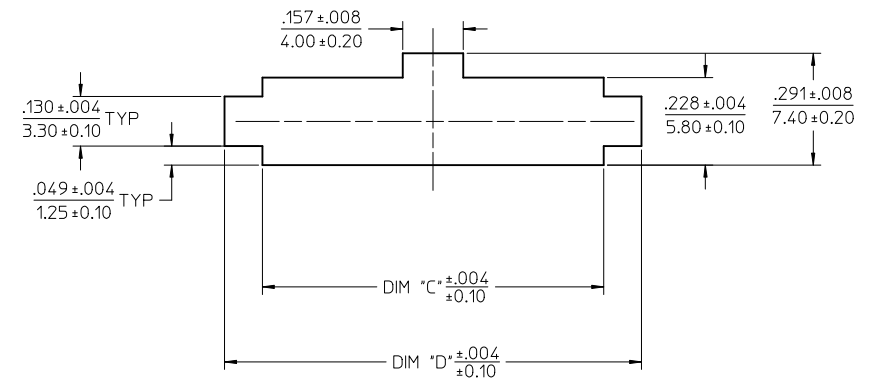

RECOMMENDED PANEL CUT-OUT
(SEE NOTE 10 & 11)

SEE SHEET 1 EC NO: UCP2011-3562 DRAWN BY: DRWANGUYEN 2011/05/18 CHKD: JBELL 2011/05/18 APPR: FSMITH 2011/08/05 A5	QUALITY SYMBOLS 	GENERAL TOLERANCES (UNLESS SPECIFIED)		DIMENSION STYLE IN/MM		SCALE 1:1	DESIGN UNITS METRIC	THIRD ANGLE PROJECTION		
			mm	INCH	DRAWN BY	DATE	TITLE MINI-FIT JR. SERIES PLUG SINGLE ROW (GLOW WIRE)			
			4 PLACES ± .004	± .010	LSCHMIDT	2007/07/02	MOLEX INCORPORATED			
			3 PLACES ± .004	± .010	ADERR	2007/07/03	MATERIAL NO. SD-5559-525			
		2 PLACES ± 0.25	± .015	APPROVED BY	DATE	DOCUMENT NO.		SHEET NO.		
		1 PLACE ± 0.38	± .015	FSMITH	2011/03/10	SEE SHEET 1		2 OF 2		
		ANGULAR ± 1/2°		DRAFT WHERE APPLICABLE MUST REMAIN WITHIN DIMENSIONS		THIS DRAWING CONTAINS INFORMATION THAT IS PROPRIETARY TO MOLEX INCORPORATED AND SHOULD NOT BE USED WITHOUT WRITTEN PERMISSION				