

## PACKAGING

PACKAGING TYPE:  
Bulk

## SCHEMATIC

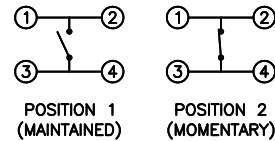

## SPECIFICATIONS

FUNCTION:  
1P1T OFF--(ON)

RATINGS:  
50mA 12VDC

OPERATING FORCE:  
100±50gf

TRAVEL:  
0.010+0.008/-0.004 [0.25+0.02/-0.1]

CONTACT RESISTANCE:  
Initial: 100mΩ Max.

INSULATION RESISTANCE:  
100MΩ Min. at 500VDC

DIELECTRIC STRENGTH:  
250VAC For 1 Minute

ELECTRICAL LIFE:  
200,000 Cycles

SHOCK RESISTANCE:  
Mil-Std. 202F, Method 213B

VIBRATION RESISTANCE:  
Mil-Std. 202F, Method 201A

TEMPERATURE:  
Operating: -25°C to 70°C  
Storage: -30°C to 80°C

## APPROVALS:

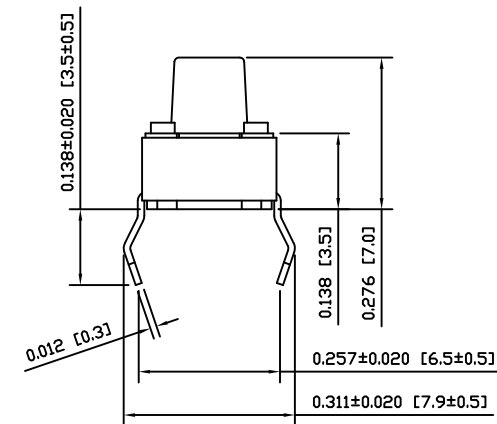
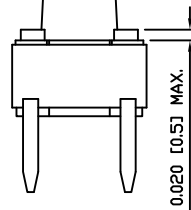
**RoHS LEAD FREE**  
COMPLIANT PROCESS COMPATIBLEPOSITION 1 =  
POSITION 2 =

## SUGGESTED PCB LAYOUT

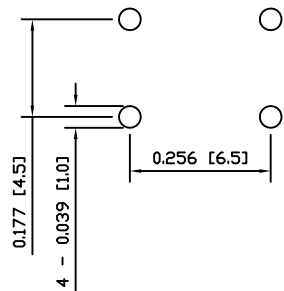

## MATERIALS

BASE:  
Polyamide 9T (PA9T), UL94 V-0

COVER:  
Stainless Steel

ACTUATOR:  
Polyamide 9T (PA9T), UL94 V-0

CONTACTS:  
Silver Clad Phosphor Bronze

TERMINALS:  
Silver Plated Brass

ACTUATOR	A	10/03/06	CAB
BODY	A	10/03/17	CAB
COLORS	A	10/03/17	CAB
MATERIALS	A	10/03/06	CAB
PACKAGING	A	10/03/06	CAB
SPECIFICATIONS	A	10/03/17	CAB
REFERENCE	REV.	DATE	BY

THE INFORMATION CONTAINED IN THIS DOCUMENT IS PROPRIETARY TO E-SWITCH AND IS NOT TO BE COPIED OR TRANSFERRED

A	INITIAL RELEASE	19566	11/01/06	CAB
REV.	DESCRIPTION	PCR	DATE	DRAWN BY

DIMENSIONS	INCHES [MILLIMETERS]
GENERAL TOLERANCES	±0.008 [±0.2] / ±1°
SCALE	DRAWING NOT TO SCALE
PROJECTION	

E-SWITCH	LAMB INDUSTRIES
TITLE	TS-7.0-100
ITEM NUMBER	06-TS70100
DATE	JANUARY 6, 2011
REVISION	A