

**MICRO SWITCH**  
a Honeywell Division

FED.MFG.CODE 91929

MAGNET

CATALOG LISTING

103MG6

THIS DRAWING COVERS A PROPRIETARY ITEM AND IS THE PROPERTY OF MICRO SWITCH, A DIVISION OF HONEYWELL. THIS DRAWING IS NOT TO BE COPIED OR USED WITHOUT THE APPROVAL OF MICRO SWITCH.

103MG6

PAGE 1 OF 1

M

DRAWING  
NUMBER

3

ISSUE

REPLACES X90850-MC

RELEASE NO. PR-18072

CHECK

REVISIONS

A C071786  
J A S  
30 DEC 91  
B C095439  
G J W  
4 AUG 99

CHECK

CHECK D A W 9 FEB 90

J A S 9 FEB 90

FORMTEK

DRAWN

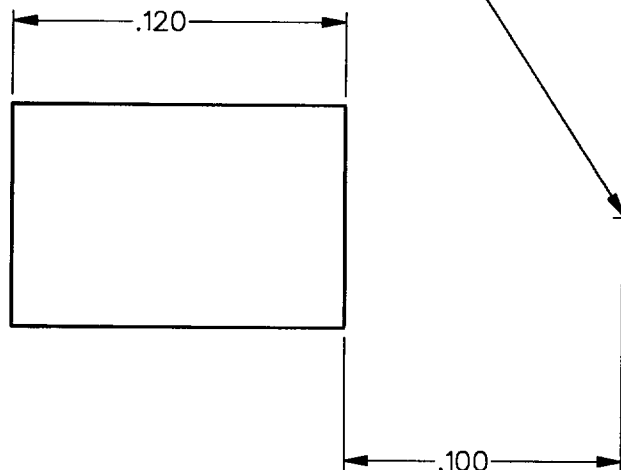
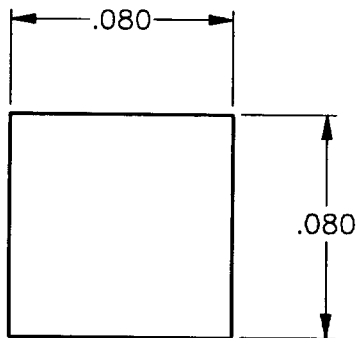

NOTES

- 1 - THE MAGNET IS RARE EARTH MAGNETIZED AND CONDITIONED FOR OPERATION
- 2 - READING IN GAUSS WITH F.W. BELL 620 GAUSS METER AND PROBE STJ4-0402 AT .100±.001 FROM SOUTH POLE TO HALL PROBE ELEMENT AT TEMPERATURE OF 25±1°C SHALL BE 200 GAUSS MINIMUM
- 3 - POLES NOT MARKED
- 4 - PACKED 75 PIECES EACH TUBE, TUBES TO BE MARKED WITH RED DOT INDICATING NORTH POLE

THIRD ANGLE PROJECTION

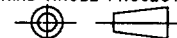

SCALE 15 : 1

DO NOT SCALE PRINT

UNLESS OTHERWISE SPECIFIED  
TOLERANCES ARE

ONE PLACE	(.0)	±.030
TWO PLACE	(.00)	±.015
THREE PLACE	(.000)	±.005
ANGLES		±

WEIGHT