

HONEYWELL PART NUMBER
22AC2
KCQ0020

REV	DOCUMENT	CHANGED BY	CHECK
5	0019211	RKP 08JUN06	DVM

PUSH TO OPERATE-RETURNS
AUTOMATICALLY TO POSITION
SHOWN
PULL TO OPERATE-REMAINS IN
OPERATED POSITION UNTIL RESET
FOR AUTOMATIC RETURN BY NEXT
FULL STROKE "PUSH" OPERATION

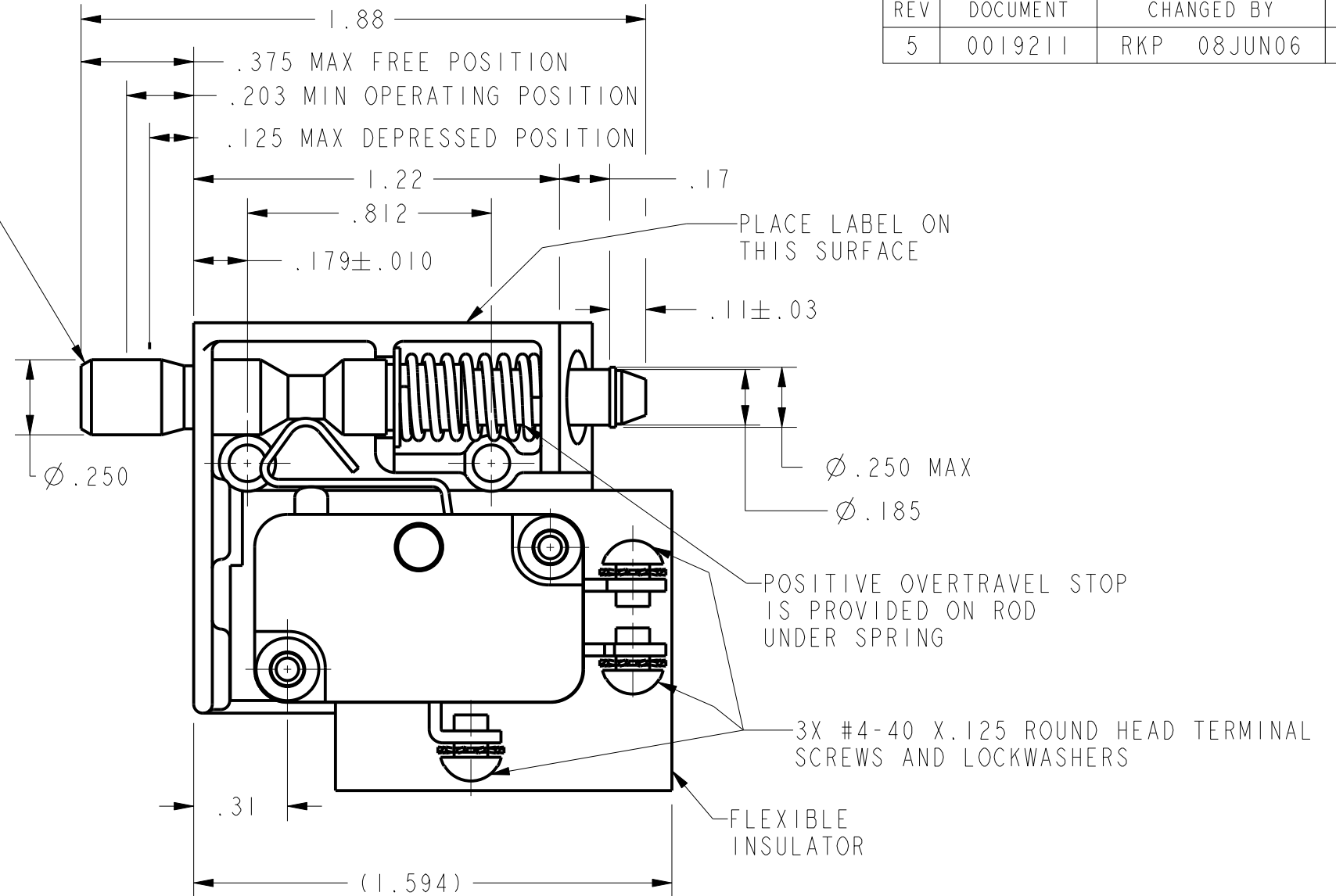
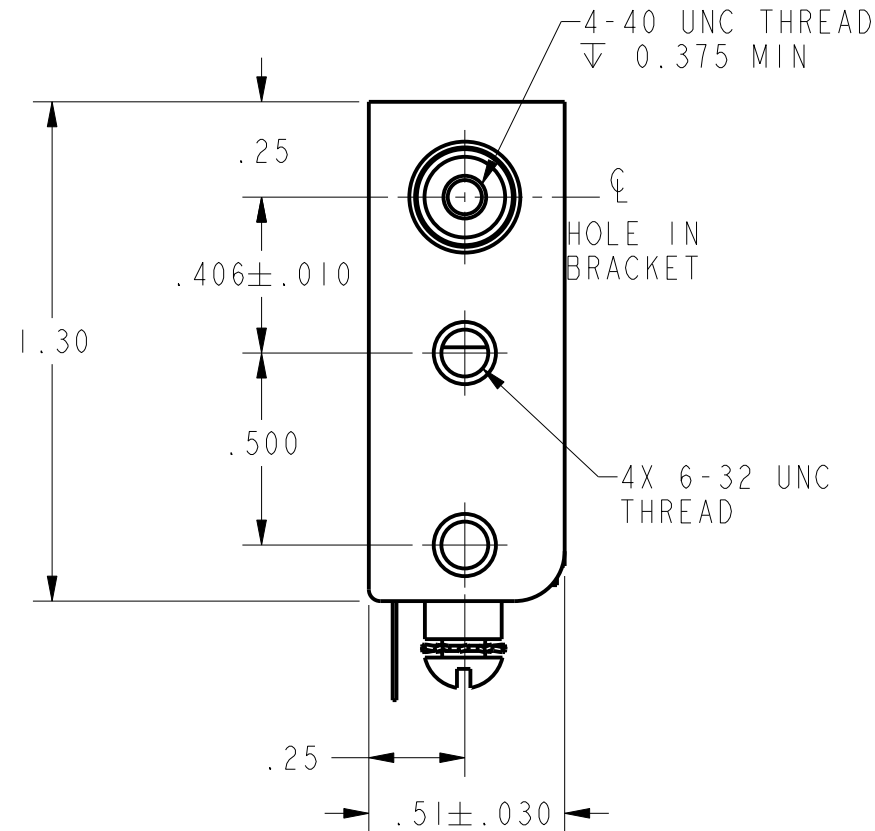

NOTES

1. NOTCH IN ACTUATOR ROD WILL PERMIT .035 DISPLACEMENT BETWEEN END OF ROD AND HOLE IN BRACKET
2. UNIT INCLUDES CATALOG LISTING "V3L-15" BASIC SWITCH
3. BASIC SWITCH PLASTIC PARTS ARE MADE OF GLASS AND MINERAL FILLED PHENOLIC AND TEFLON FILLED PHENOLIC
4. ACTUATOR ROD MADE OF HIGH STRENGTH PLASTIC
5. UL AND CSA APPROVALS APPLY TO BASIC SWITCH ONLY
6. WITH ROD IN EITHER ACTUATED POSITION, BASIC SWITCH PLUNGER MUST HAVE .015 MIN OVERTRAVEL AND WITH ROD IN FREE POSITION BASIC SWITCH PLUNGER MUST HAVE .005 MIN RELEASETRAVEL

CHARACTERISTICS	ELECTRICAL DATA	DESIGN UNITS: INCH	DRAWN	DVM	03MAR06	Honeywell		
		TOLERANCES UNLESS NOTED:	CHECK	RJ	03MAR06			
TOTAL TRAVEL:	CONTACT ARRANGEMENT	NO PLACE .X ±	THIS DRAWING COVERS A PROPRIETARY ITEM AND IS THE PROPERTY OF HONEYWELL. THIS DRAWING IS NOT TO BE COPIED OR USED WITHOUT THE PERMISSION OF HONEYWELL.			TITLE		
.250 APPROX PUSH DIRECTION	S P D T	ONE PLACE .X ±						
.187 APPROX PULL DIRECTION	15.1A 1/2 HP 125, 250, 277VAC	TWO PLACE .XX ±				INTERPRET PER ASME Y14.5M-1994 OTHER HONEYWELL ENGINEERING STANDARDS MAY APPLY		
FULLY DEPRESSED FORCE-- 4 LBS MAX	1/2 A 125 VDC, 1/4 A 250 VDC 5A 125 VAC "L"	THREE PLACE .XXX ±						
		FOUR PLACE .XXXX ±	B	I	22AC2	5		
		ANGLES .X ±	SCALE	2:1	SHEET 1 OF 1			
		THIRD ANGLE PROJECTION	Pro/ENGINEER	3D				