

MICRO SWITCH

a Honeywell Division

FED.MFG.CODE 91929

ASSEMBLY— PUSHBUTTON SWITCH

CATALOG LISTING
2PB455-T

CATALOG LISTING
2PB455-T

PAGE 1 OF 1

ISSUE
3

REPLACES

RELEASE NO. PR-22214

CHECK

CHECK

03 NOV 98

J A F

CHECK

06 JUN 96

J A K

REVISIONS

A	PR22214
J A K	6 JUN 96
B	CO-93593
P P F	03 NOV 98

DDM/CAD
DRAWN

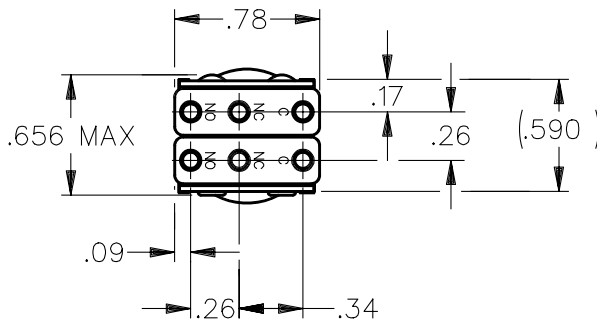
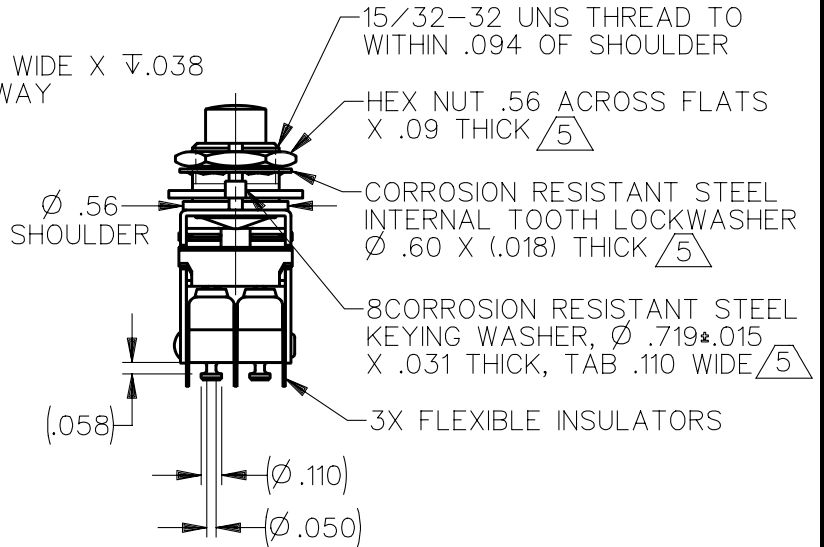
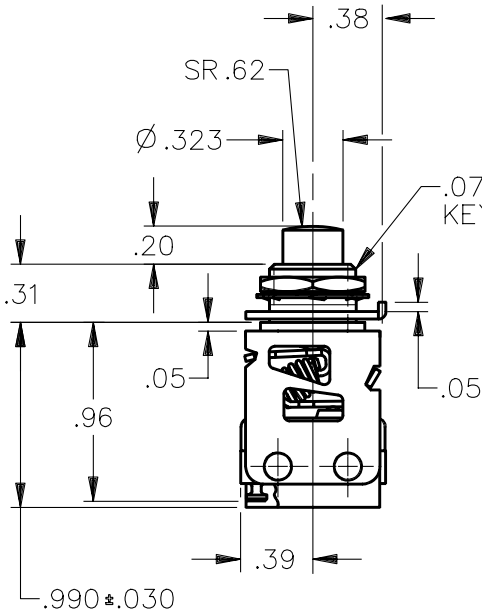

NOTES

- 1 - UNIT INCLUDES 2X "11SM" TYPE BASIC SWITCH
- 2 - SWITCHES DO NOT NECESSARILY OPERATE SIMULTANEOUSLY
- 3 - TERMINALS ARE GOLD PLATED
- 4 - BASIC SWITCHES HAVE 24K SOLID GOLD CONTACTS
- 5 MOUNTING HARDWARE FURNISHED UNASSEMBLED
- 6 - CORROSION RESISTANT STEEL PLUNGER, BUSHING AND BRACKET

ANSI Y14.5M-1982 APPLIES

THIS DRAWING COVERS A PROPRIETARY ITEM AND IS THE PROPERTY OF MICRO SWITCH, A DIVISION OF HONEYWELL. THIS DRAWING IS NOT TO BE COPIED OR USED WITHOUT THE APPROVAL OF MICRO SWITCH.

THIRD ANGLE PROJECTION

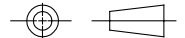

CHARACTERISTICS	ELECTRICAL DATA	SCALE FULL	DO NOT SCALE PRINT
OPERATING FORCE — — — 22 N APPROX	CONTACT ARRANGEMENT 2X S P D T	UNLESS OTHERWISE SPECIFIED TOLERANCES ARE	
TOTAL TRAVEL — — — 3.2 mm APPROX	30 VOLTS DC RATING		
PRETRAVEL — — — — 1.2 mm MIN	INDUCTIVE — — — — — SEA LEVEL — 1/2 AMP	ONE PLACE (.0)	±.030
DIFFERENTIAL TRAVEL — — — 1.27 mm MAX	RESISTIVE — — — — — SEA LEVEL — 1 AMP	TWO PLACE (.00)	±.015
OVERTRAVEL — — — — — .8 mm MIN	MAXIMUM INRUSH — — — — — 2 AMP	THREE PLACE (.000)	±.005
		ANGLES	±
		WEIGHT	