

- NOTES:
- MATERIAL: HOUSING: SPS, GLASS FILLED, COLOR: SEE CHART. TERMINAL: COPPER ALLOY C26000. PIN ALIGNMENT PLATE: MYLAR, COLOR: NATURAL (WHITE).
  - FINISHES: TERMINAL: TIN (Sn) OVERALL; NICKEL (Ni) UNDERPLATE OVERALL.
  - PACKAGING SPECIFICATION : TRAY: PK-30907-2261, TUBE: PK-30907-226
  - MATES WITH: SERIES 30700, SEE SALES DRAWING SD-30700-124.
  - DATECODE DESCRIPTION:
    - 1ST DIGIT: MACHINE ID# (ALWAYS WILL BE '2')
    - 2ND THROUGH 4TH DIGIT: DAY# OF THE CALENDAR YEAR (EXAMPLE: FEB. 3RD = '034')
    - 5TH DIGIT: LAST DIGIT OF THE CALENDAR YEAR (EXAMPLE: 1999 = '9')
    - 6TH THROUGH 7TH DIGIT: HOUR OF THE DAY.
  - RECOMMENDED OPTIONAL SCREW: M2 x 0.89, 6mm IN LENGTH, PAN COLLAR HEAD, 6 LOBE. TORQUE: 7 NEWTON CENTIMETERS

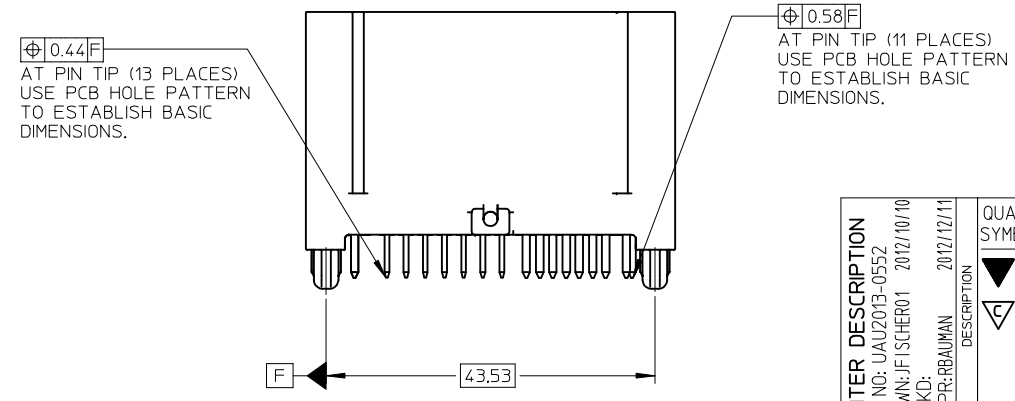

ENTER DESCRIPTION EC NO: UAU2013-0552 DRWN: JFSCHER01 2012/10/10 CHKD: APPR: RBAUMAN 2012/12/11	QUALITY SYMBOLS ▽=0 ▽=0	GENERAL TOLERANCES (UNLESS SPECIFIED)	DIMENSION STYLE MM ONLY	SCALE 2:1	DESIGN UNITS METRIC	THIRD ANGLE PROJECTION
		mm INCH	DRAWN BY RCARLSON	DATE 01/04/04	TITLE 24 CIRCUIT VERTICAL HEADER ASSEMBLY SALES DRAWING	
		4 PLACES $\pm$ --- $\pm$ ---	CHECKED BY CKRISHNA	DATE 01/04/24	MATERIAL NO. 9999999999	SHEET NO. 1 OF 2
		3 PLACES $\pm$ --- $\pm$ ---	APPROVED BY LGEIB	DATE 01/04/24		
		2 PLACES $\pm 0.13$ $\pm$ ---	DOCUMENT NO. SD-30700-424		THIS DRAWING CONTAINS INFORMATION THAT IS PROPRIETARY TO MOLEX INCORPORATED AND SHOULD NOT BE USED WITHOUT WRITTEN PERMISSION	
		1 PLACE $\pm 0.25$ $\pm$ ---				
		ANGULAR $\pm 1^\circ$				
		DRAFT WHERE APPLICABLE MUST REMAIN WITHIN DIMENSIONS				

PACKAGING		POLARIZATION OPTIONS & COLOR	
ASSEMBLY P/N TRAY PACKED	ASSEMBLY P/N TUBE PACKED	VERTICAL HEADER ASSEMBLY (POLARIZATION OPTIONS)	HOUSING COLOR
30700-4240	30700-4244	POLARIZATION OPTION 'A'	GRAY
30700-4241	30700-4245	POLARIZATION OPTION 'B'	BLACK
30700-4242	30700-4246	POLARIZATION OPTION 'C'	NATURAL
---	30700-4248	POLARIZATION OPTION 'A'	GRAY
---	30700-4249	POLARIZATION OPTION 'B'	BLACK
---	30700-4247	POLARIZATION OPTION 'C'	NATURAL

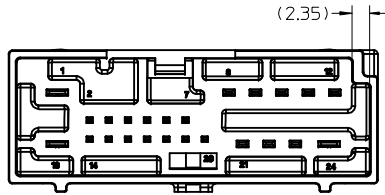

30700-4240  
POLARIZATION 'A'

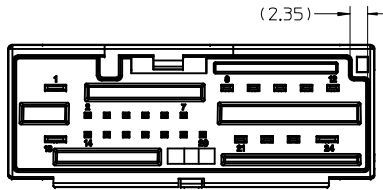

30700-4248  
POLARIZATION 'A'

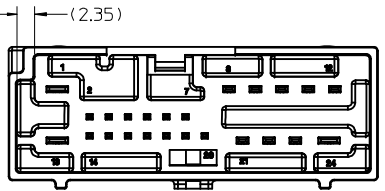

30700-4241  
POLARIZATION 'B'

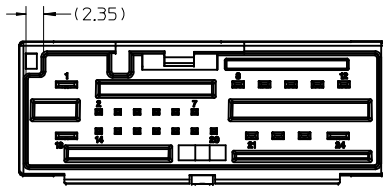

30700-4249  
POLARIZATION 'B'

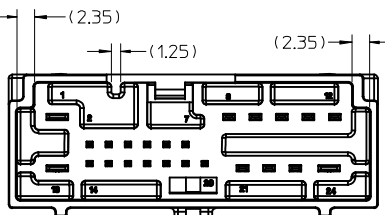

30700-4242  
POLARIZATION 'C'

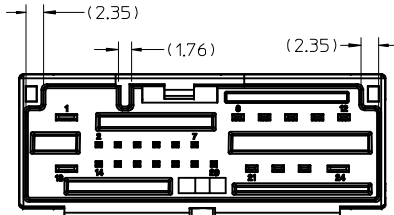

30700-4247  
POLARIZATION 'C'

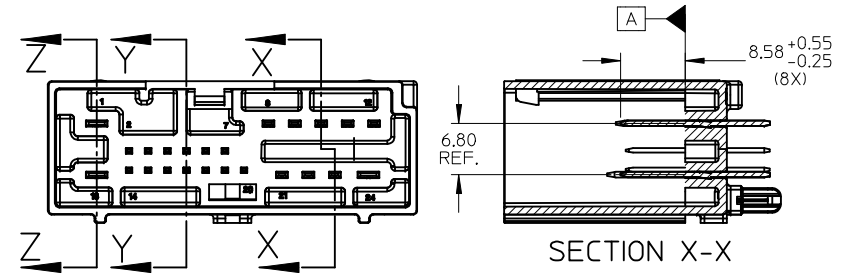

SECTION X-X

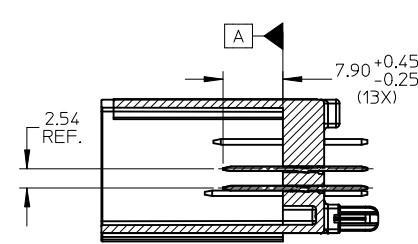

SECTION Y-Y

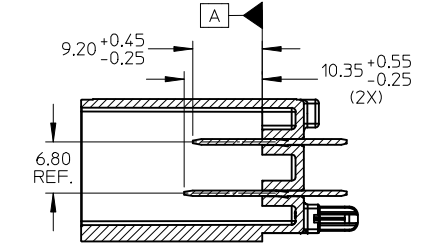

SECTION Z-Z

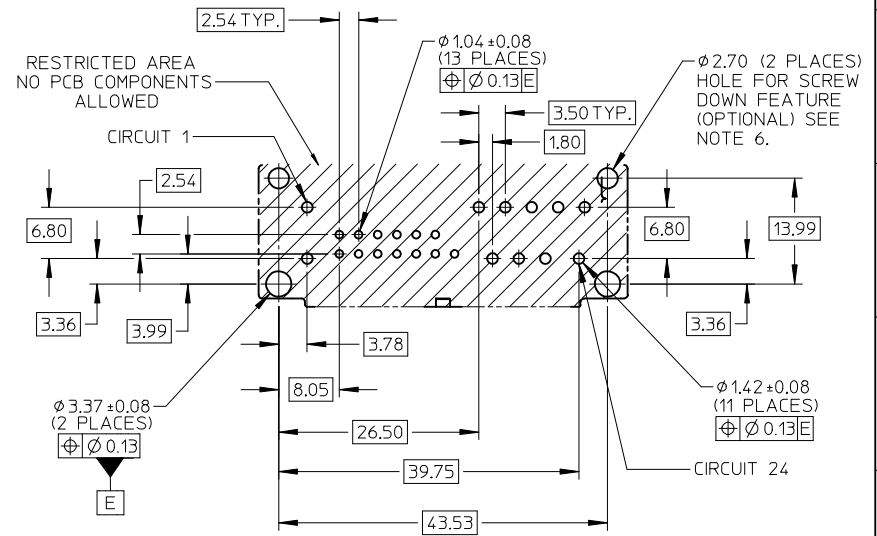

PCB LAYOUT: COMPONENT SIDE  
RECOMMENDED PCB THICKNESS: 1.57±0.17

FIX PIN LENGTH TOL EC NO: UAU2013-0552 DRWN: F. SCHER01 2012/10/10 CHKD: APPR: RBAUMAN 2012/12/11 REV: F2	QUALITY SYMBOLS ▽=0 ▽=0	GENERAL TOLERANCES (UNLESS SPECIFIED) <table border="1"> <tr> <th></th> <th>mm</th> <th>INCH</th> </tr> <tr> <td>4 PLACES</td> <td>± ---</td> <td>± ---</td> </tr> <tr> <td>3 PLACES</td> <td>± ---</td> <td>± ---</td> </tr> <tr> <td>2 PLACES</td> <td>± 0.13</td> <td>± ---</td> </tr> <tr> <td>1 PLACE</td> <td>± 0.25</td> <td>± ---</td> </tr> <tr> <td colspan="3">ANGULAR ± 1 °</td> </tr> </table>		mm	INCH	4 PLACES	± ---	± ---	3 PLACES	± ---	± ---	2 PLACES	± 0.13	± ---	1 PLACE	± 0.25	± ---	ANGULAR ± 1 °			DIMENSION STYLE <b>MM ONLY</b> DRAWN BY: R. CARLSON DATE: 01/04/04 CHECKED BY: CKRISHNA DATE: 01/04/24 APPROVED BY: LGEIB DATE: 01/04/24	SCALE: 2:1 DESIGN UNITS: METRIC THIRD ANGLE PROJECTION
		mm	INCH																			
	4 PLACES	± ---	± ---																			
	3 PLACES	± ---	± ---																			
2 PLACES	± 0.13	± ---																				
1 PLACE	± 0.25	± ---																				
ANGULAR ± 1 °																						
DRAFT WHERE APPLICABLE MUST REMAIN WITHIN DIMENSIONS		MATERIAL NO.: 9999999999 SIZE: C	TITLE: 24 CIRCUIT VERTICAL HEADER ASSEMBLY SALES DRAWING MOLEX MOLEX INCORPORATED DOCUMENT NO.: SD-30700-424 SHEET NO.: 2 OF 2																			
THIS DRAWING CONTAINS INFORMATION THAT IS PROPRIETARY TO MOLEX INCORPORATED AND SHOULD NOT BE USED WITHOUT WRITTEN PERMISSION																						