

1

2

3

4

5

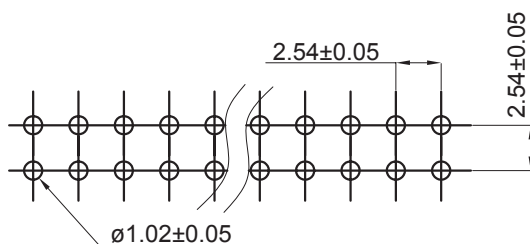
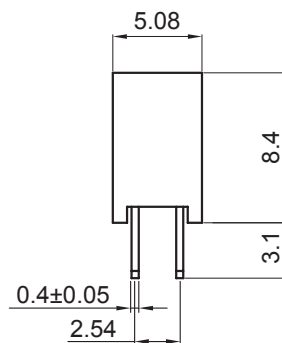
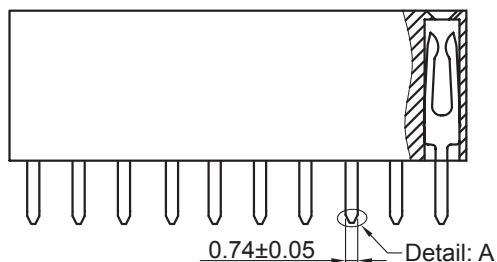
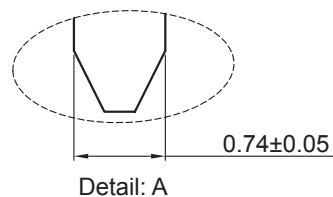
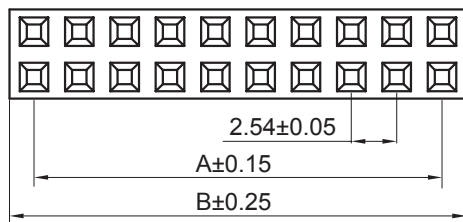

PCB LAYOUT - COMPONENT VIEW

TECHNICAL CHARACTERISTICS

MATERIAL

INSULATOR: PBT
 COLOR: BLACK
 CONTACT MATERIAL: COPPER ALLOY
 CONTACT TYPE: STAMPED
 CONTACT PLATING: GOLD
 QUALITY CLASS: 3 AS PER CECC 75 301-802
 PITCH: 2.54MM

ENVIRONMENTAL

OPERATING TEMPERATURE: -40 UP TO 125°C
 FLAMABILITY RATING: UL94-V0
 COMPLIANCE: LEAD FREE AND ROHS

ELECTRICAL

CURRENT RATING: 3A
 WORKING VOLTAGE: 250V AC
 INSULATOR RESISTANCE: >1000 mOHM
 DIELECTRIC WITHSTANDING VOLTAGE: 500V AC/MN
 CONTACT RESISTANCE: 20 mOHM MAX

STANDARD

☑ CERTIFIED: E323964 / MODEL N° 613-218

SOLDERING

WAVE PROCESS ONLY

PACKAGING

TRAY

DIMENSION

A= 2.54 x (NB. PIN / 2-1)
 B= 2.54 x (NB. PIN / 2) + 0.5

RoHS Compliant

G	25-NOV-09	STANDARD	JP	PROJECTION: 	GENERAL TOLERANCE .X = +/- 0.2 .XX = +/- 0.15		
F	23-AVR-09	PACKAGING	JC				
E	23-NOV-07	MODIFICATIONS	EC				
D☐	19-DEC-06	0.74MM PINS☐	JP				
C☐	30-MAR-04☐	LEAD FREE☐	JP	APPROVAL: RJ	UNIT: MM	DESCRIPTION: 2.54MM DUAL SOCKET HEADER	
B☐	10-MAR-04☐	☐ ☐	JP		SCALE:		
H	08-APR-13	DIMENSION	AR		SHEET: 1/2		WERI PART NO: 613 0xx 218 21
REV	DATE	FILE	BY		DRAW: PEARL		

SIZE

A4

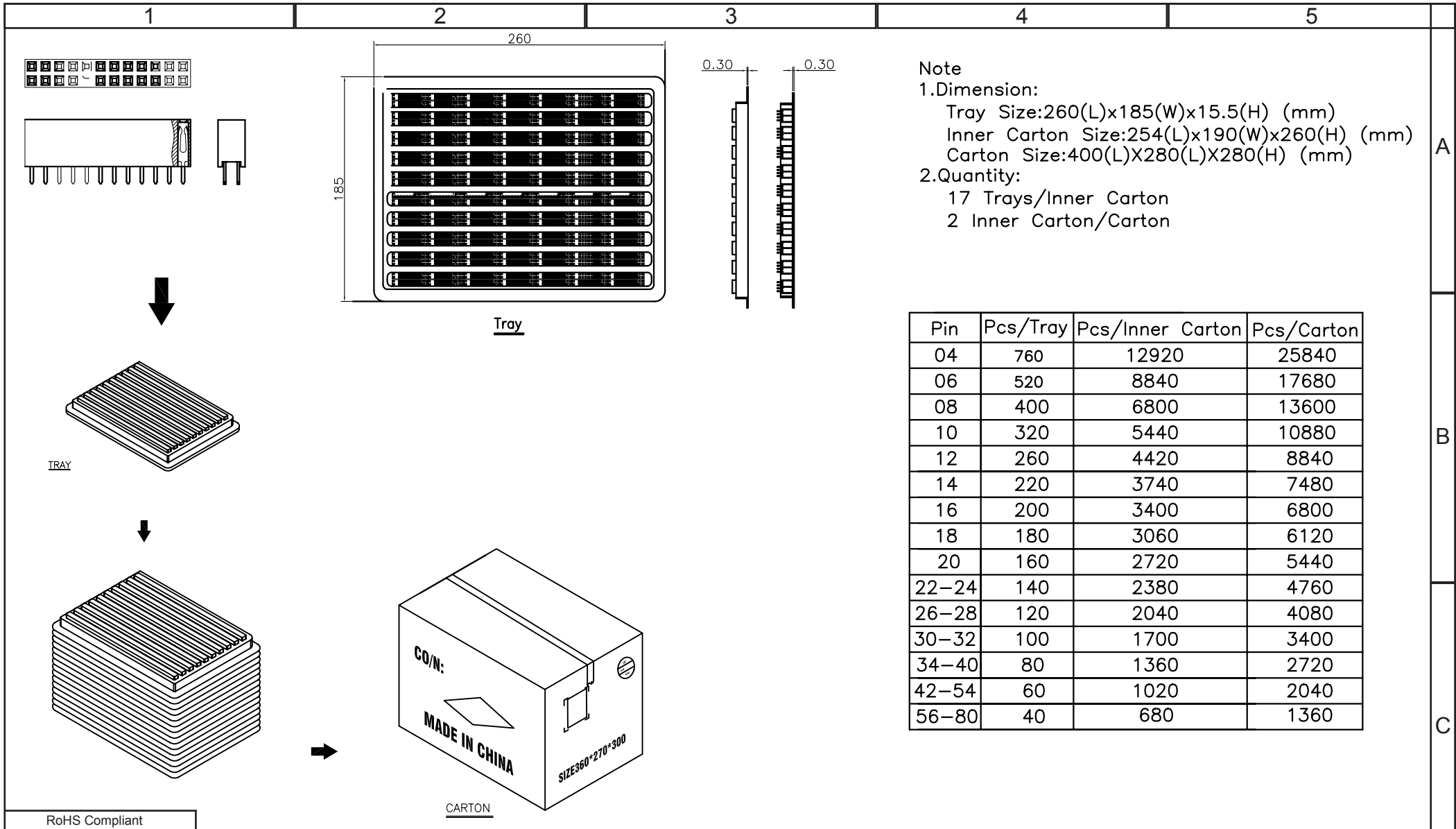

RoHS Compliant			
G			
F			
E			
D			
C			
B			
A			
REV	DATE	FILE	BY

CARTON

PROJECTION:

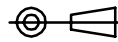

APPROVAL: RJ

GENERAL TOLERANCE

.X = +/- 0.2
.XX = +/- 0.15

UNIT: MM

SCALE:

SHEET: 2/2

DRAW: PEARL



DESCRIPTION: 2.54MM DUAL SOCKET HEADER

WERI PART NO: 6130 xx 21821_TPK

SIZE

A4