

1 2 3 4 5

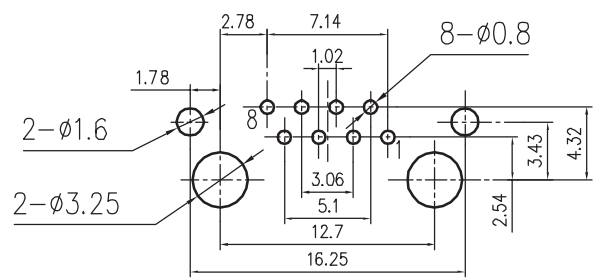

PCB LAYOUT

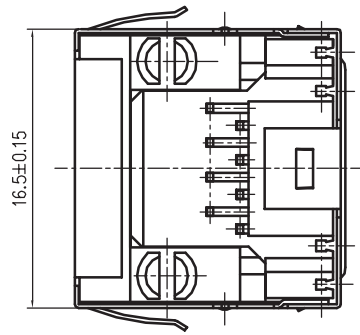
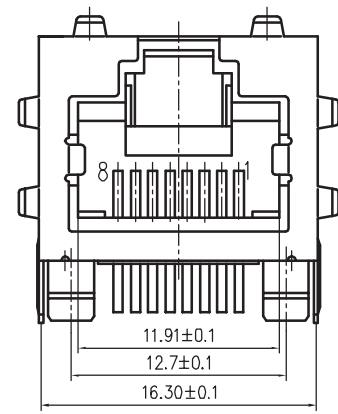
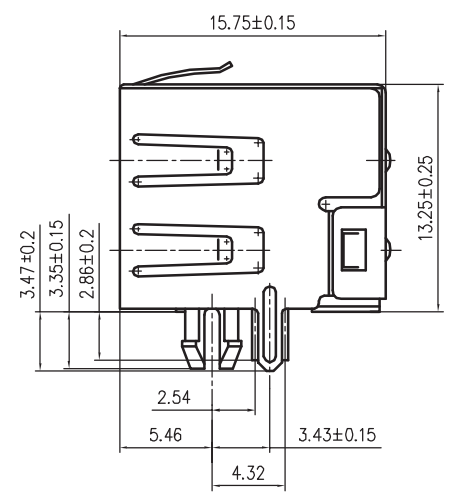

TECHNICAL CHARACTERISTICS

MATERIAL
 INSULATOR MATERIAL: PBT
 FLAMMABILITY RATING UL94-V0
 COLOUR: BLACK
 CONTACT MATERIAL: COPPER ALLOY
 CONTACT TYPE: STAMPED
 CONTACT PLATING: GOLD
 SHIELDING: BRONZE NI PLATED
 QUALITY CLASS: 500 MATING CYCLES

ENVIRONMENTAL
 OPERATING TEMPERATURE: -25 °C UP TO 85 °C
 COMPLIANCE: LEAD FREE AND ROHS

ELECTRICAL
 CURRENT RATING: 1.5 A
 WORKING VOLTAGE: 120 VAC
 INSULATION RESISTANCE: >500 MOHM
 DIELECTRIC WITHSTANDING VOLTAGE: 1 000 VAC/MN
 CONTACT RESISTANCE: 20 mOHM MAX

SOLDERING
 WAVE PROCESS ONLY

PACKAGING
 TRAY

G			
F			
E			
D	26-AUG-13	DIM UPDATE	QL
C	20-AUG-13	DIM UPDATE	QL
B	06-OCT-09	CHARACTERISTICS	JP
A	03-FEB-07	PDF	CH
REV	DATE	FILE	BY

PROJECTION:	GENERAL TOLERANCE
	.X = +/- 0.2
APPROVAL: RJ	.XX = +/- 0.15
UNIT: MM	
SCALE:	
SHEET: 1/1	
DRAW:	

DESCRIPTION: HORIZONTAL SHIELDED WITH EMI PANEL FINGER 8P8C MODULAR JACK TAP UP

WERI PART NO: 615008140621

SIZE
A4

A
 B
 C
 D