

PART NUMBER	DESCRIPTION	DIM "A" PC TAIL LENGTH	PLATING
75561-5200	SHORT PC TAIL - NO PEG	3.07/1.21	30μ INCH MIN SELECT HARD GOLD IN CONTACT AREA WITH 100μ INCH MIN SELECT TIN IN TAIL AREA OVER 50μ INCH MIN NICKEL OVERALL
75561-5201	LONG PC TAIL - NO PEG	3.81/1.50	
75561-1520	SHORT PC TAIL - PEG	3.07/1.21	30μ INCH MIN SELECT HARD GOLD IN CONTACT AREA WITH 100μ INCH MIN SELECT TIN IN TAIL AREA OVER 50μ INCH MIN NICKEL OVERALL
75561-1521	LONG PC TAIL - PEG	3.81/1.50	

NOTES:

1. MATERIALS:
- HOUSING: 30% GLASS FILLED, LCP 94V-0, COLOR: BLACK
- TERMINALS: COPPER ALLOY
PLATING: PER ES-88 - SEE CHART
2. SEE CHART FOR REFERENCE DOCUMENTS
3. PLUG MATES WITH RECEPTACLE ASSEMBLIES: 75545-5100 & 75545-5101
4. MODULE IS DESIGNED FOR SOLDERING TO THE PCB
5. MODULE ASSEMBLY IS ROHS COMPLIANT
6. GATHERABILITY: ±0.65/0.26 X-DIRECTION
±1.30/0.51 Y-DIRECTION

A2

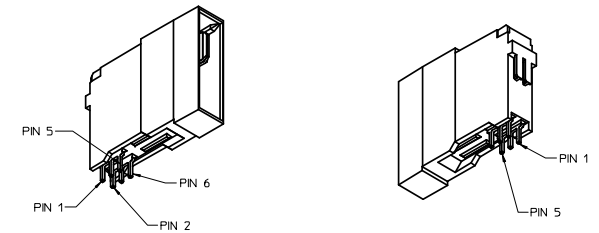
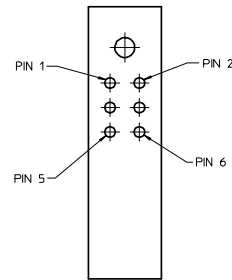
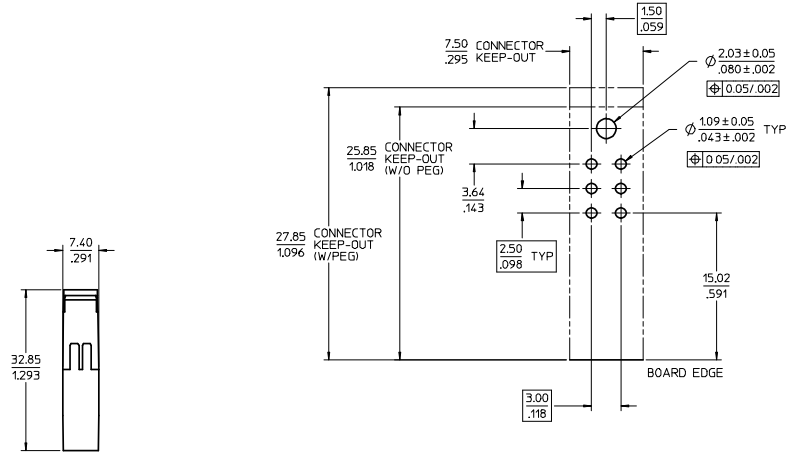

A3 PCB LAYOUT SCALE: 4:1

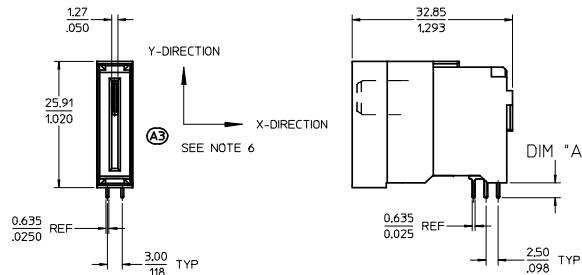

75561-5*** SHOWN (W/O PEG)

SAME AS 75561-5*** EXCEPT AS SHOWN

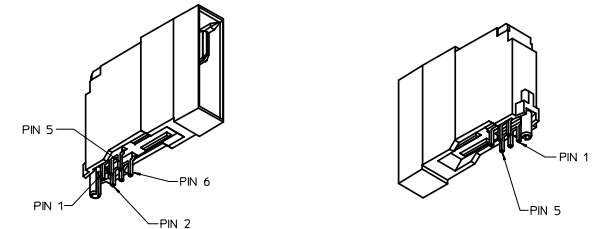

REFERENCE DOCUMENTS	
PS-75431-999	PRODUCT SPECIFICATION: PERFORMANCE AND RATINGS
SD-75555-***	FINAL ASSEMBLY CONFIGURATION DRAWING

A3
A3

REV/ADD NOTES	QUALITY SYMBOLS	GENERAL TOLERANCES (UNLESS SPECIFIED)		DIMENSION STYLE	SCALE	DESIGN UNITS	THIRD ANGLE PROJECTION
		mm	INCH	MM/IN	2:1	METRIC	☉
REV 001: UCP2008-1370 2008/01/02	▽=0	4 PLACES ±---	±---	DRAWN BY JSCHAFFER	DATE 2007/01/10	TITLE POWER DOCK SR. 40 AMP MODULE, PLUG UPPER	
REV 002: DUILLES 2008/01/03	▽=0	3 PLACES ±---	±.008	CHECKED BY MDATA	DATE 2007/01/12	MOLEX INCORPORATED	
REV 003: APPROPRIATEL 2008/01/09	▽=0	2 PLACES ±0.20	±.013	APPROVED BY APATEL	DATE 2007/01/12	DOCUMENT NO. SD-75561-102	SHEET NO. 1 OF 1
A3	▽=0	1 PLACE ±0.33	±---	MATERIAL NO. SEE CHART		THIS DRAWING CONTAINS INFORMATION THAT IS PROPRIETARY TO MOLEX INCORPORATED AND SHOULD NOT BE USED WITHOUT WRITTEN PERMISSION	
		DRAFT WHERE APPLICABLE MUST REMAIN WITHIN DIMENSIONS					