

NOTES:

1. MATERIALS:

HOUSING - LIQUID CRYSTAL POLYMER (LCP),
UL94 V-0, COLOR: BLACK.
TERMINAL - COPPER ALLOY

2. FINISH: 30 μ IN MIN. GOLD ON MATING SURFACE;
MATTE TIN ON TAILS; NICKEL UNDERPLATE.

3. FINISH: 50 μ IN MIN. GOLD ON MATING SURFACE;
MATTE TIN ON TAILS; NICKEL UNDERPLATE.

4. THIS PART CONFORMS TO PRODUCT SPECIFICATION
PS-74031-999.

5. SINGLE ROW ASSEMBLY PACKED PER PK-70873-0876.

6. MATES WITH 75885 SERIES DAUGHTERCARD POWER ASSEMBLY.

7. MATING INTERFACE MEASURED FROM BOTTOM OF HOUSING.

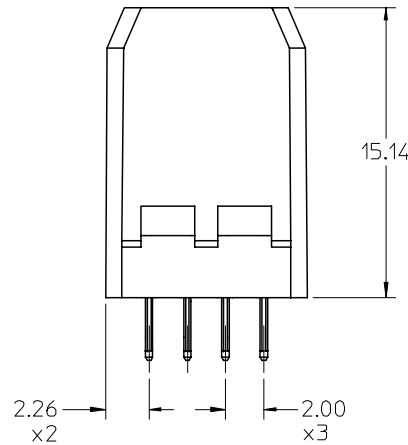
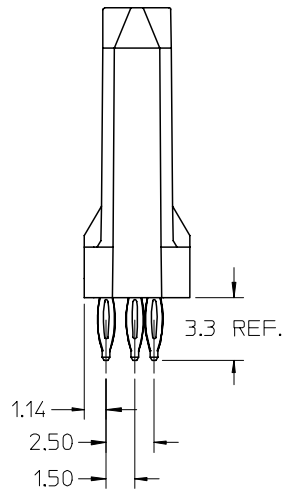
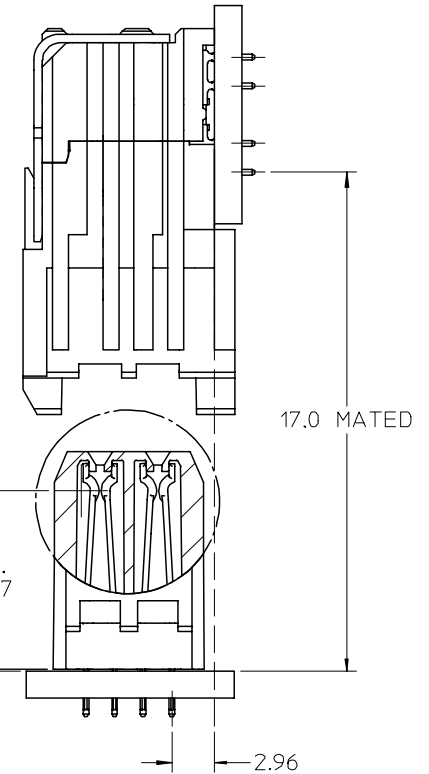
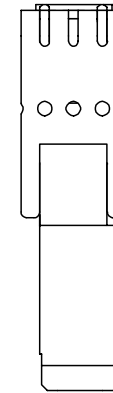
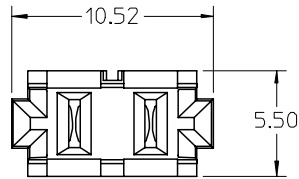

SINGLE ROW ASSEMBLY

MOLEX P/N	GOLD THICKNESS
75888-6000	30uin
75888-6050	50uin

INITIAL RELEASE EC NO: UCP2005-2659 DRWN: JONIAK 2005/09/01 CHKD: SREED 2005/09/01 APPR: CBILXR 2005/09/02	QUALITY SYMBOLS ▽ = 0 ◻ = 0	DESCRIPTION	GENERAL TOLERANCES (UNLESS SPECIFIED)		SCALE 4:1	DESIGN UNITS METRIC	THIRD ANGLE PROJECTION	REVISE ON CAD ONLY																
			<table><tr><td></td><td>mm</td><td>INCH</td></tr><tr><td>4 PLACES</td><td>± ---</td><td>± ---</td></tr><tr><td>3 PLACES</td><td>± ---</td><td>± ---</td></tr><tr><td>2 PLACES</td><td>± ---</td><td>± ---</td></tr><tr><td>1 PLACE</td><td>± ---</td><td>± ---</td></tr></table>			mm	INCH	4 PLACES	± ---	± ---	3 PLACES	± ---	± ---	2 PLACES	± ---	± ---	1 PLACE	± ---	± ---	DIMENSION STYLE MM ONLY		TITLE VHDM/HSD POWER 6 ROW BACKPLANE LEAD FREE SALES ASSEMBLY		
				mm	INCH																			
			4 PLACES	± ---	± ---																			
			3 PLACES	± ---	± ---																			
2 PLACES	± ---	± ---																						
1 PLACE	± ---	± ---																						
DRAWN BY JJONIAK		DATE 2005/08/09																						
CHECKED BY JJONIAK		DATE 2005/08/09		MOLEX INCORPORATED																				
APPROVED BY JJONIAK		DATE 2005/08/09		MATERIAL NO. SEE CHART	DOCUMENT NO. SD-75888-006	SHEET NO. 1 OF 3																		
A	REV		DRAFT WHERE APPLICABLE MUST REMAIN WITHIN DIMENSIONS		THIS DRAWING CONTAINS INFORMATION THAT IS PROPRIETARY TO MOLEX INCORPORATED AND SHOULD NOT BE USED WITHOUT WRITTEN PERMISSION					B														

NOTES:

1. THIS DESIGN INTENDED AS OPTION TO HAVING TWO SINGLE ROW MODULES NEXT TO EACH OTHER.
2. FINISH: 30 μ IN GOLD ON MATING SURFACE; MATTE TIN ON TAILS; NICKEL UNDERPLATE.
3. FINISH: 50 μ IN GOLD ON MATING SURFACE; MATTE TIN ON TAILS; NICKEL UNDERPLATE.
4. DUAL ROW ASSEMBLIES PACKED PER PK-70873-545.

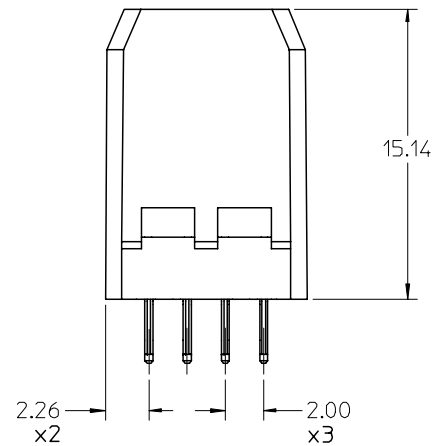
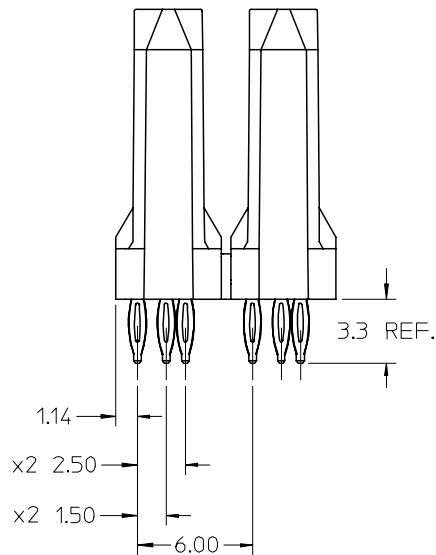
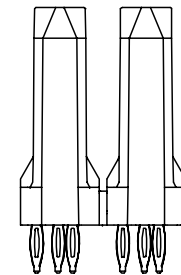
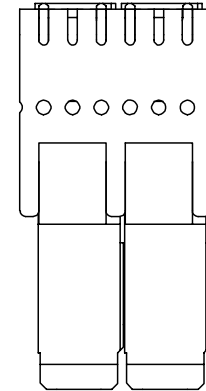
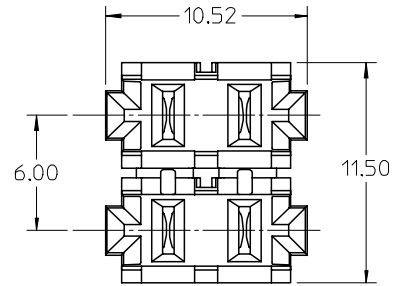

DUAL ROW ASSEMBLY

MOLEX P/N	CONTACT PLATING
75888-6002	SEE NOTE 2.
75888-6052	SEE NOTE 3.

INITIAL RELEASE EC NO: UCP2005-2659 DRWN: JONIAK 2005/09/01 CHKD: SREED 2005/09/01 APPR: CBILXR 2005/09/02	QUALITY SYMBOLS ▽ = 0 ▽ = 0	GENERAL TOLERANCES (UNLESS SPECIFIED) <table><tr><td></td><td>mm</td><td>INCH</td></tr><tr><td>4 PLACES</td><td>± ---</td><td>± ---</td></tr><tr><td>3 PLACES</td><td>± ---</td><td>± ---</td></tr><tr><td>2 PLACES</td><td>± ---</td><td>± ---</td></tr><tr><td>1 PLACE</td><td>± ---</td><td>± ---</td></tr></table> ANGULAR ± 5 °		mm	INCH	4 PLACES	± ---	± ---	3 PLACES	± ---	± ---	2 PLACES	± ---	± ---	1 PLACE	± ---	± ---	SCALE 4:1	DESIGN UNITS METRIC	THIRD ANGLE PROJECTION	REVISE ON CAD ONLY
				mm	INCH																
			4 PLACES	± ---	± ---																
			3 PLACES	± ---	± ---																
			2 PLACES	± ---	± ---																
1 PLACE	± ---	± ---																			
DIMENSION STYLE MM ONLY		TITLE VHDM/HSD POWER 6 ROW BACKPLANE LEAD FREE SALES ASSEMBLY																			
DRAWN BY JJONIAK		DATE 2005/08/09		MOLEX INCORPORATED																	
CHECKED BY JJONIAK		DATE 2005/08/09																			
A	REV	DESCRIPTION DRAFT WHERE APPLICABLE MUST REMAIN WITHIN DIMENSIONS	APPROVED BY JJONIAK		DATE 2005/08/09	MATERIAL NO. SEE CHART	DOCUMENT NO. SD-75888-006	SHEET NO. 2 OF 3													
			THIS DRAWING CONTAINS INFORMATION THAT IS PROPRIETARY TO MOLEX INCORPORATED AND SHOULD NOT BE USED WITHOUT WRITTEN PERMISSION					B													

BOARD LAYOUTS: 1.8 mm MIN. BOARD THICKNESS

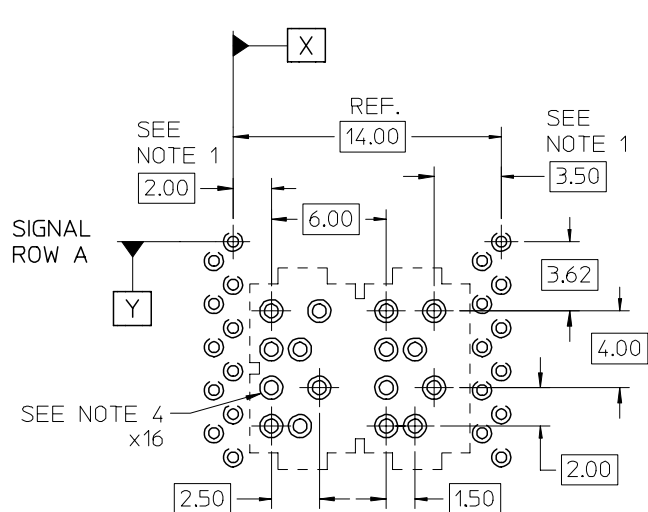

VHDM DUAL ROW POWER

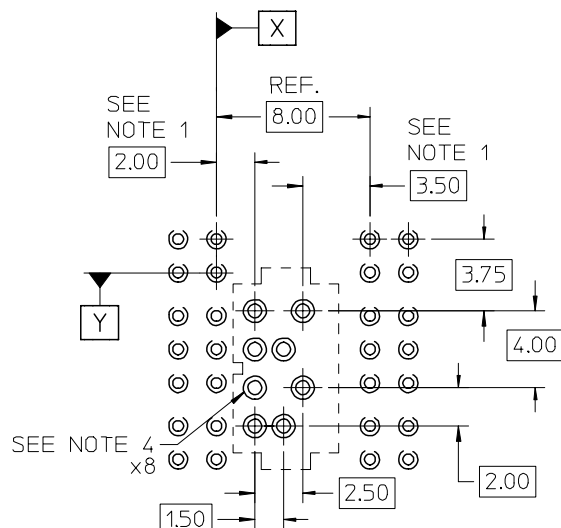

VHDM-HSD SINGLE ROW POWER

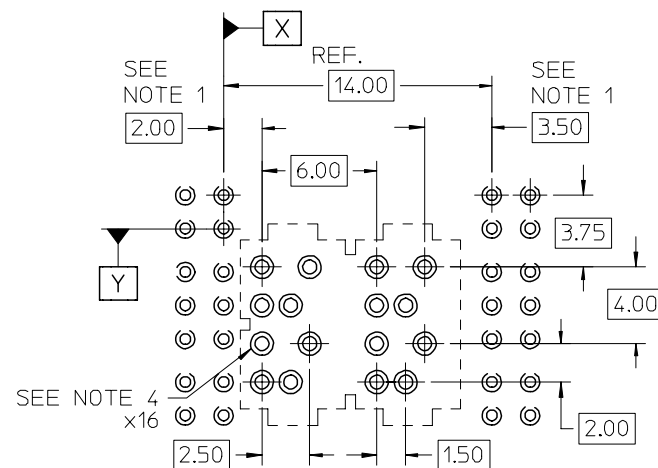

VHDM-HSD DUAL ROW POWER

NOTES:

1. ADDITIONAL SPACING CAN BE ADDED IN MULTIPLES OF 2.0 mm AS REQUIRED. FOR EACH ADDITIONAL SINGLE ROW POWER, ADD 6.00 mm.
2. SIGNAL ROW A IS IN LINE WITH DATUM Y IN ALL FOUR LAYOUTS.
3. FOUR HOLES ARE USED PER POWER CONTACT.
4. EACH POWER HOLE TO BE MANUFACTURED AS FOLLOWS:

Ø 0.725±0.075 PLATED THROUGH HOLE

Ø 1.20 PAD

Ø 0.838 DRILL

⊕ 0.10 X Y

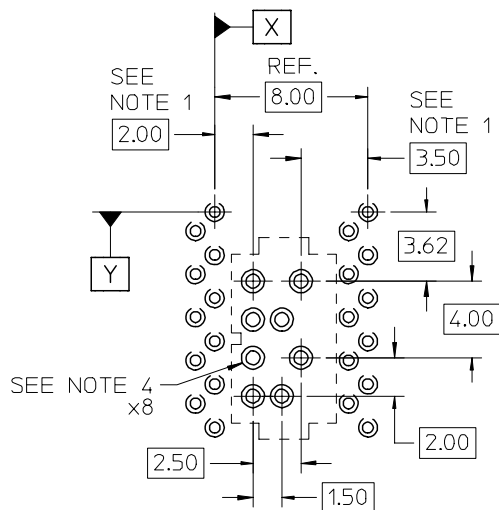

VHDM SINGLE ROW POWER

INITIAL RELEASE EC NO: UCP2005-2659 DRWN: JONIAK 2005/09/01 CHKD: SREED 2005/09/01 APPR: CBXILR 2005/09/02	QUALITY SYMBOLS	DESCRIPTION	GENERAL TOLERANCES (UNLESS SPECIFIED)		SCALE 4:1	DESIGN UNITS METRIC	THIRD ANGLE PROJECTION		REVISE ON CAD ONLY					
				mm	INCH	DIMENSION STYLE MM ONLY		TITLE VHDM/HSD POWER 6 ROW BACKPLANE LEAD FREE SALES ASSEMBLY MOLEX MOLEX INCORPORATED						
			4 PLACES	± ---	± ---	DRAWN BY JJONIAK	DATE 2005/08/09							
			3 PLACES	± ---	± ---	CHECKED BY JJONIAK	DATE 2005/08/09							
			2 PLACES	± ---	± ---	APPROVED BY JJONIAK					DATE 2005/08/09	MATERIAL NO. SEE SHT 1 & 2	DOCUMENT NO. SD-75888-006	SHEET NO. 3 OF 3
A	REV		1 PLACE	± ---	± ---	ANGULAR ± 5 °		DRAFT WHERE APPLICABLE MUST REMAIN WITHIN DIMENSIONS			THIS DRAWING CONTAINS INFORMATION THAT IS PROPRIETARY TO MOLEX INCORPORATED AND SHOULD NOT BE USED WITHOUT WRITTEN PERMISSION			B