

- NOTES:
- MATERIAL: LIQUID CRYSTALLINE POLYMER (LCP), GLASS FILLED, UL 94V-0, COLOR: BLACK.  
 TERMINAL & SOLERTAB: COPPER ALLOY  
 PICK & PLACE CAP: PA46, UL 94V-0, COLOR: BLACK.
  - PLATING:  
 CONTACT: 0.76µm MIN. SELECTIVE GOLD OVER 1.27µm MIN.  
 NICKEL UNDERPLATE  
 SOLDER TAIL: 2.54µm MIN. TIN OVER 1.27µm MIN. NICKEL UNDERPLATE  
 SOLDER TAB: 2.54µm MIN. TIN OVER 1.91µm MIN. NICKEL UNDERPLATE.
  - MOLEX LOGO LOCATED APPROXIMATELY AS SHOWN
  - PACKAGING: REFER TO ATTACHED
  - DATE CODE TO BE LOCATED APPROXIMATELY AS SHOWN.
  - PRODUCT IS COMPLIANT TO RoHS DIRECTIVE WITH THE FOLLOWING BANNED SUBSTANCES - LEAD, MERCURY, CADMIUM, HEXAVALENT CHROMIUM, POLYBROMINATED BIPHENYLS AND POLYBROMINATED DIPHENYL ETHERS.
  - PRODUCT SPECIFICATION PS-78367-001 APPLIES.
  - MATES WITH: SFF-8482 PLUG  
 SATA PLUG SERIES: 87679, 87703, 87799.
  - NON-FUNCTIONAL CORING MAY VARY.

PART NUMBER	DIM A	PACKAGING	DIM B	DIM C
78367-0001	2.00	TRAY	ø2.48	ø2.50
78367-0003	1.00	TRAY		
78367-0005	2.00	TAPE & REEL	ø1.26	ø1.40
78367-0006	1.00	TAPE & REEL		
78367-0007	1.00	TRAY		
78367-0008		TAPE & REEL		

ADD PART NO EC NO: S2011-0804 DRWN: CGOH CHKD: SCHEONG APPR: BOKOK	2011/03/22 2011/04/05 2011/04/05	QUALITY SYMBOLS F <sub>A</sub> =0 F <sub>C</sub> =0 F <sub>P</sub> =0	GENERAL TOLERANCES (UNLESS SPECIFIED)		DIMENSION STYLE MM ONLY		SCALE NTS	DESIGN UNITS METRIC	THIRD ANGLE PROJECTION		
				mm	INCH	DRAWN BY	DATE	TITLE			
			4 PLACES	± ---	± ---	BOKOK	2008/02/01	SAS RECEPTACLE EXTENDED HEIGHT, SMT WITH SOLDER TAB			
			3 PLACES	± ---	± ---	CHECKED BY	DATE				
2 PLACES	± 0.20	± ---	YKOH	2008/02/18	MOLEX INCORPORATED						
1 PLACE	± ---	± ---	APPROVED BY	DATE							
ANGULAR ± 3 °			DRAFT WHERE APPLICABLE MUST REMAIN WITHIN DIMENSIONS		SEE TABLE		MATERIAL NO. DOCUMENT NO.		SHEET NO.		
A4			REV		SIZE A3		SD-78367-001		1 OF 5		

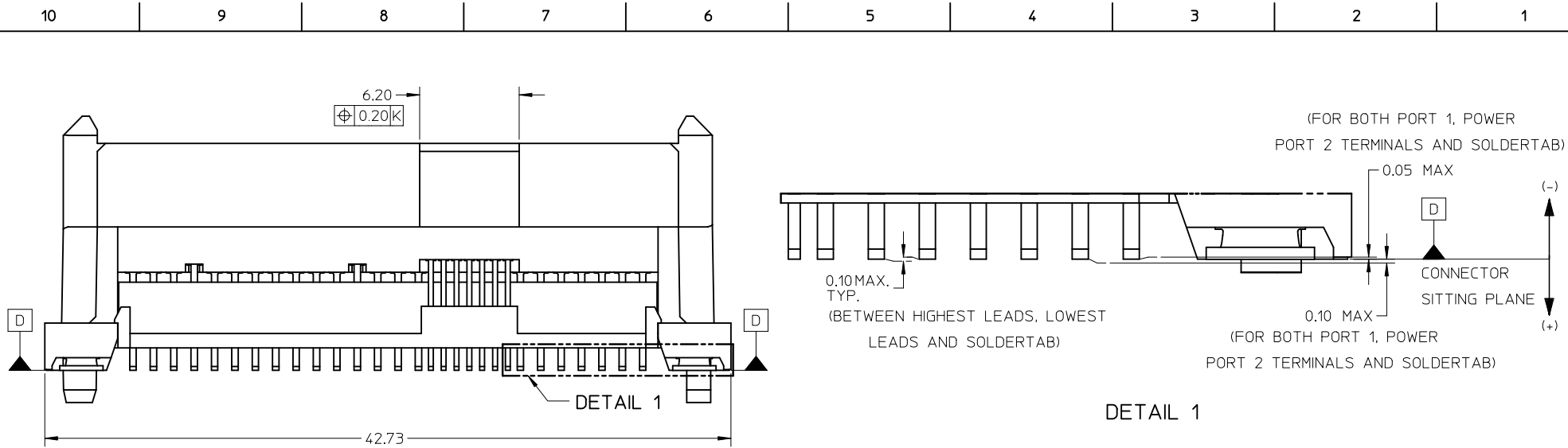

DETAIL 1

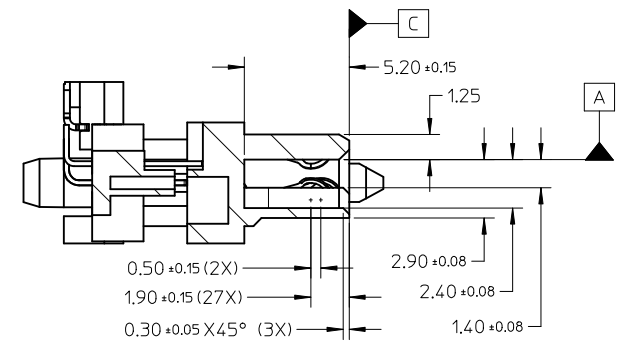
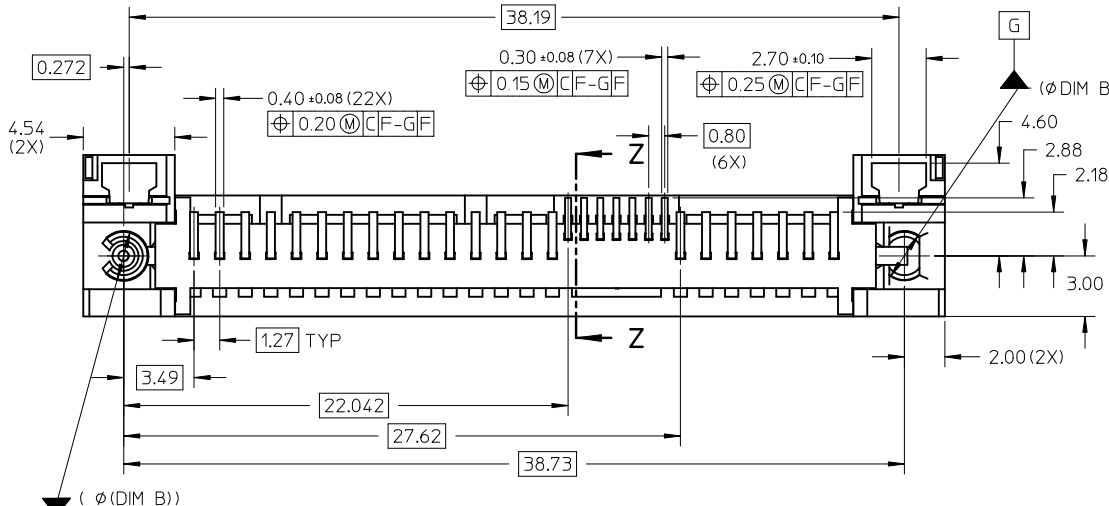

SECTION Z-Z

ADD PART NO EC NO: S2011-0804 DRWN:CGOH CHKD:SCHEONG APPR:BOKKOK	2011/03/22 2011/04/05 2011/04/05	DESCRIPTION REV	QUALITY SYMBOLS	GENERAL TOLERANCES (UNLESS SPECIFIED)	DIMENSION STYLE	SCALE	DESIGN UNITS	THIRD ANGLE PROJECTION															
			$\nabla_A = 0$ $\nabla_C = 0$ $\nabla_P = 0$	<table border="1"> <tr> <th></th> <th>mm</th> <th>INCH</th> </tr> <tr> <td>4 PLACES</td> <td>± ---</td> <td>± ---</td> </tr> <tr> <td>3 PLACES</td> <td>± ---</td> <td>± ---</td> </tr> <tr> <td>2 PLACES</td> <td>± 0.20</td> <td>± ---</td> </tr> <tr> <td>1 PLACE</td> <td>± ---</td> <td>± ---</td> </tr> </table>		mm	INCH	4 PLACES	± ---	± ---	3 PLACES	± ---	± ---	2 PLACES	± 0.20	± ---	1 PLACE	± ---	± ---	MM ONLY	NTS	METRIC	<input checked="" type="checkbox"/> THIRD ANGLE PROJECTION
				mm	INCH																		
			4 PLACES	± ---	± ---																		
3 PLACES	± ---	± ---																					
2 PLACES	± 0.20	± ---																					
1 PLACE	± ---	± ---																					
ANGULAR ± 3 °	DRAFT WHERE APPLICABLE MUST REMAIN WITHIN DIMENSIONS	DRAWN BY BOKKOK	DATE 2008/02/01	TITLE SAS RECEPTACLE EXTENDED HEIGHT, SMT WITH SOLDER TAB																			
A4	A3	MATERIAL NO. SEE TABLE	DATE 2010/02/19	MOLEX INCORPORATED	DOCUMENT NO. SD-78367-001	SHEET NO. 2 OF 5																	

10 9 8 7 6 5 4 3 2 1

F

E

D

C

B

A

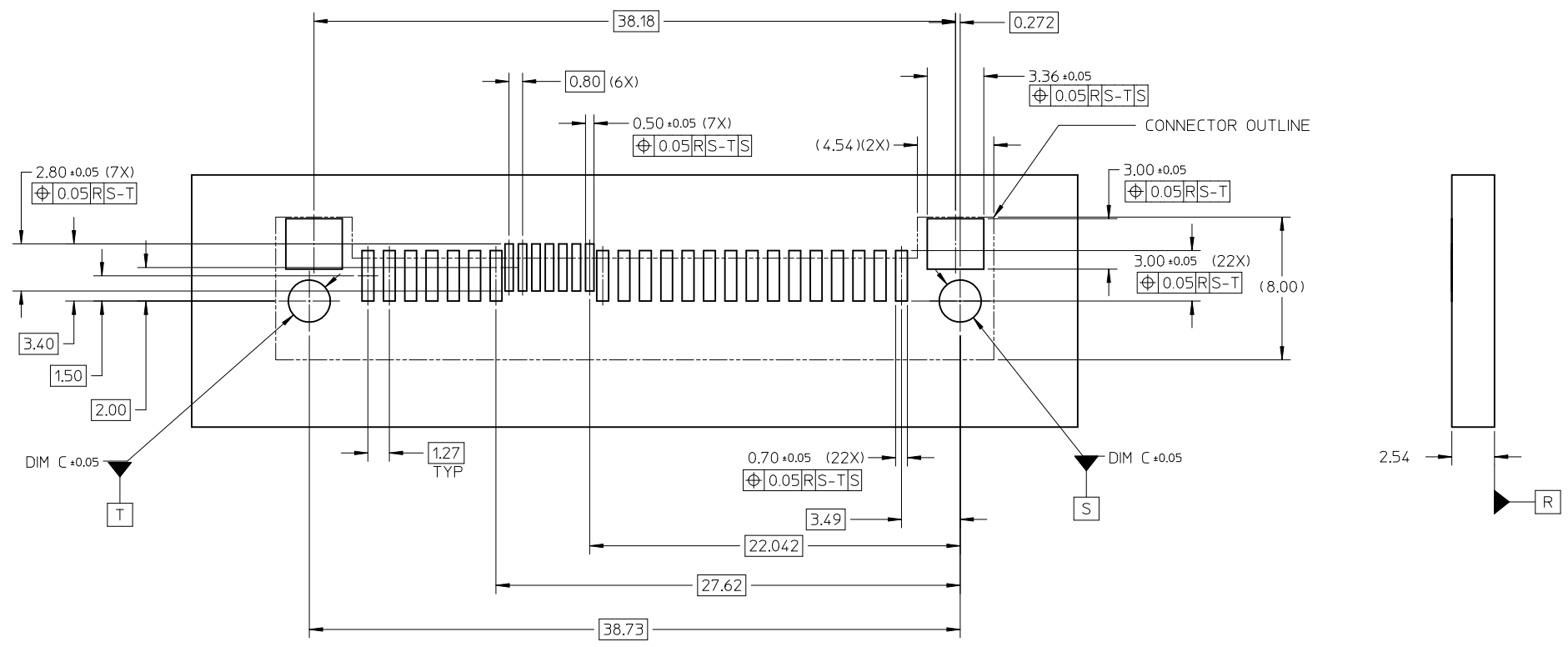

RECOMMENDED PCB LAYOUT

<b>ADD PART NO</b> EC NO: S2011-0804 DRWN:CGOH CHKD:SCHEONG APPR:BOKKOK	2011/03/22 2011/04/05 2011/04/05	QUALITY SYMBOLS $F_A=0$ $F_C=0$ $F_P=0$	GENERAL TOLERANCES (UNLESS SPECIFIED)		DIMENSION STYLE <b>MM ONLY</b>		SCALE NTS	DESIGN UNITS METRIC	THIRD ANGLE PROJECTION			
				mm	INCH	DRAWN BY	DATE	TITLE				
			4 PLACES	± ---	± ---	BOKKOK	2008/02/01	SAS RECEPTACLE EXTENDED HEIGHT, SMT WITH SOLDER TAB				
			3 PLACES	± ---	± ---	CHECKED BY	DATE					
2 PLACES	± 0.20	± ---	YKOH	2008/02/18	MOLEX INCORPORATED							
1 PLACE	± ---	± ---	APPROVED BY	DATE								
ANGULAR ± 3 °			DRAFT WHERE APPLICABLE MUST REMAIN WITHIN DIMENSIONS		SEE TABLE		MATERIAL NO. SD-78367-001		SHEET NO. 3 OF 5			
A4			SIZE A3		THIS DRAWING CONTAINS INFORMATION THAT IS PROPRIETARY TO MOLEX INCORPORATED AND SHOULD NOT BE USED WITHOUT WRITTEN PERMISSION							

9 8 7 6 5 4 3 2 1

TRAY PACKAGING

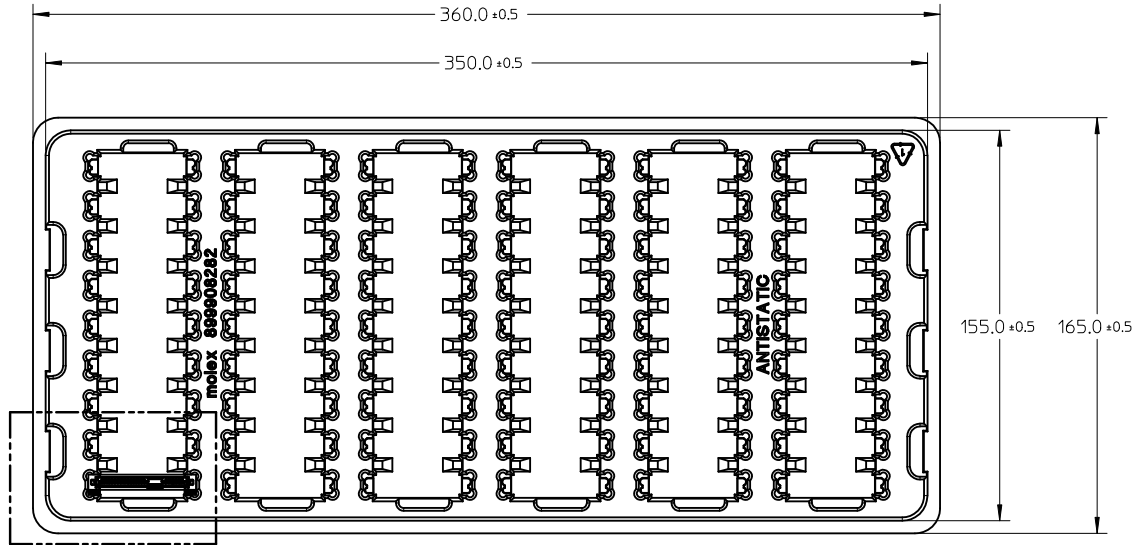

- NOTES:  
 1. PACKAGING QTY: 54PCS/TRAY  
 2. NO PICK AND PLACE CAP

DETAIL 2

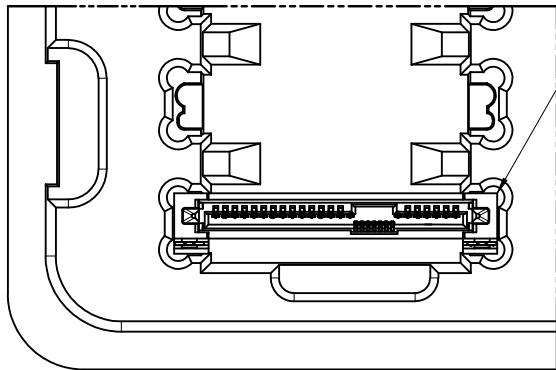

PART ORIENTATION IN TRAY

DETAIL 2

ADD PART NO EC NO: S2011-0804 DRWN:CGOH CHKD:SCHEONG APPR:BOKOK	2011/03/22 2011/04/05 2011/04/05	QUALITY SYMBOLS $\nabla_A = 0$ $\nabla_C = 0$ $\nabla_P = 0$	GENERAL TOLERANCES (UNLESS SPECIFIED)		DIMENSION STYLE	SCALE	DESIGN UNITS	THIRD ANGLE PROJECTION			
					MM ONLY	NTS	METRIC				
			mm	INCH	DRAWN BY	DATE	TITLE				
			4 PLACES ± --- ± --- 3 PLACES ± --- ± --- 2 PLACES ± 0.20 ± --- 1 PLACE ± --- ± --- ANGULAR ± 3 °		BOKOK	2008/02/01	SAS RECEPTACLE EXTENDED HEIGHT, SMT WITH SOLDERTAB				
A4	REV	DRAFT WHERE APPLICABLE MUST REMAIN WITHIN DIMENSIONS			CHECKED BY	DATE	MOLEX INCORPORATED SD-78367-001				
		SEE TABLE		YKOH	2008/02/18						
		SIZE		THIS DRAWING CONTAINS INFORMATION THAT IS PROPRIETARY TO MOLEX INCORPORATED AND SHOULD NOT BE USED WITHOUT WRITTEN PERMISSION			APPROVED BY	DATE	MATERIAL NO.	DOCUMENT NO.	SHEET NO.
A3					BOKOK	2010/02/19			4 OF 5		

TAPE AND REEL PACKAGING

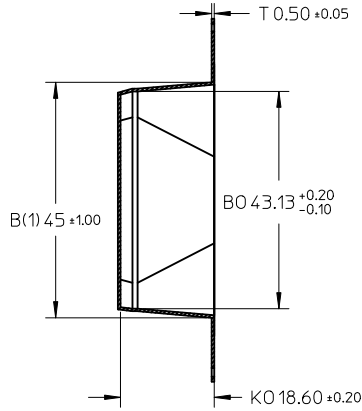

SECTION Y-Y

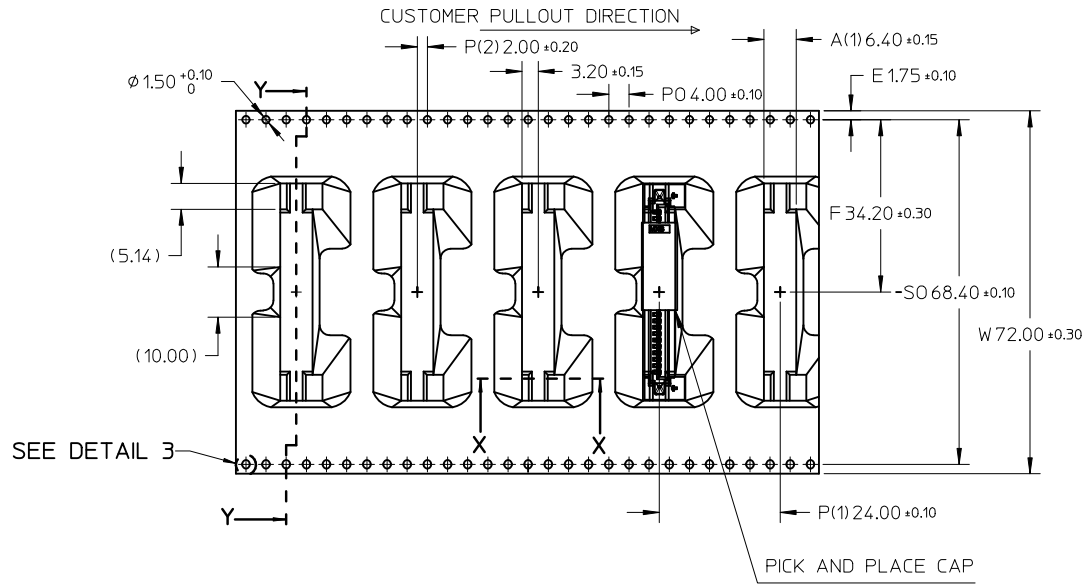

NOTES:

1. LEADER AND TRAILER TAPE

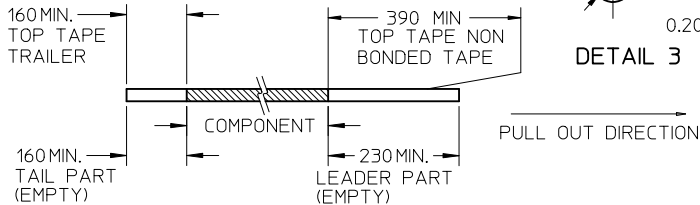

DETAIL 3

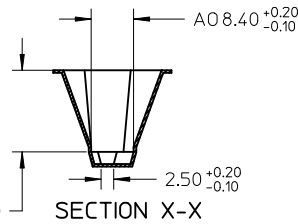

SECTION X-X

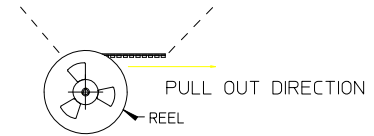

2. PEELING OFF FORCE OF THE TOP TAPE: 20 - 80gf.  
(PEELING DIRECTION AS SHOWN IN FOLLOWING FIGURE)

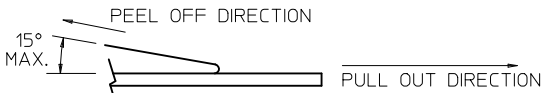

- 3. TAPE AND REEL SPECIFICATION IS AS PER EIA-481.
- 4. TAPE AND REEL QUANTITY : 100 PCS/ REEL.
- 5. THE TAPE IS TREATED FOR ANTI-STATIC.
- 6. COLOUR: BLACK. THICKNESS: 0.50mm THICK.

ADD PART NO EC NO: S2011-0804 DRWN:CGOH CHKD:SCHEONG APPR:BOKOK	DESCRIPTION 2011/03/22 2011/04/05 2011/04/05	QUALITY SYMBOLS	GENERAL TOLERANCES (UNLESS SPECIFIED)		DIMENSION STYLE	SCALE	DESIGN UNITS	THIRD ANGLE PROJECTION	
		$\nabla_A = 0$ $\nabla_C = 0$ $\nabla_P = 0$	mm	INCH	MM ONLY	NTS	METRIC		
		4 PLACES ± --- ± --- 3 PLACES ± --- ± --- 2 PLACES ± 0.20 ± --- 1 PLACE ± --- ± ---	ANGULAR ± 3 °		DRAWN BY: BOKOK CHECKED BY: YKOH APPROVED BY: BOKOK	DATE: 2008/02/01 DATE: 2008/02/18 DATE: 2010/02/19	TITLE: SAS RECEPTACLE EXTENDED HEIGHT, SMT WITH SOLDERTAB		
		DRAFT WHERE APPLICABLE MUST REMAIN WITHIN DIMENSIONS	SEE TABLE	MATERIAL NO. BOKOK	DOCUMENT NO. SD-78367-001	SHEET NO. 5 OF 5			