

DESCRIPTION: 975T D-SUB BACKSHELL - 3 WAY

MATERIAL:

PLASTIC: UL94HB, ABS PLASTIC

METALIZED: NICKEL OVER COPPER

JACKSCREWS: STEEL

HOUSING SCREWS: STEEL

OPERATING TEMP: -55°C TO +110°C

BACKSHELL KIT INCLUDES:

- (2) BACKSHELL HAVLES
- (2) 4-40 JACKSCREWS
- (2) HOUSING SCREWS (self-tapping)
- (2) STRAIN RELIEF CLAMP
- (4) STRAIN RELIEF SCREWS (self-tapping)
- (2) CABLE SLOT SHUT-OFFS

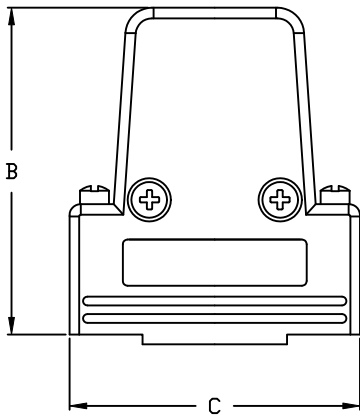
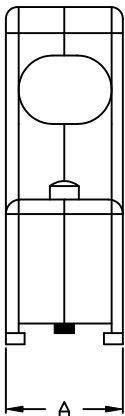

E = MAX CABLE O.D.

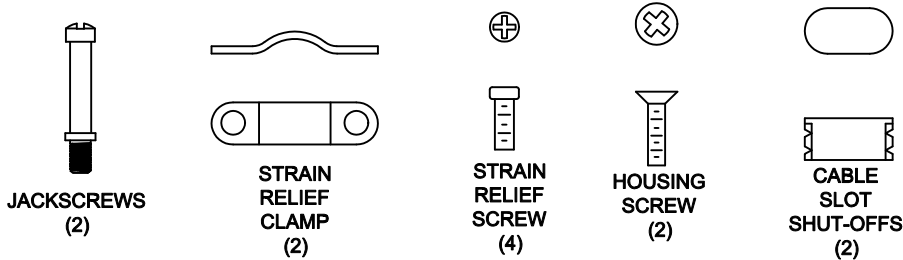
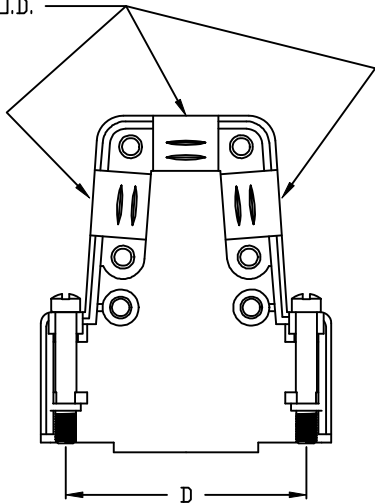

SERIES 975T YYY-YYYYYY1

POSITIONS 009
015
025
037

MATERIAL 010 = PLASTIC
020 = METALIZED

COLOR: 01 = BLACK
12 = NICKEL OVER COPPER

PUT-UPS 1 = KIT

| POS. | A | B | C | D | E |
|------|-------|-------|-------|-------|-------|
| 9 | 0.614 | 1.574 | 1.256 | 0.984 | 0.230 |
| | 15.6 | 40 | 31.9 | 25 | 5.85 |
| 15 | 0.614 | 1.771 | 1.586 | 1.311 | 0.340 |
| | 15.6 | 45 | 40.3 | 33.33 | 8.63 |
| 25 | 0.614 | 1.771 | 2.126 | 1.850 | 0.400 |
| | 15.6 | 45 | 54 | 47 | 10.16 |
| 37 | 0.614 | 1.771 | 2.775 | 2.500 | 0.400 |
| | 15.6 | 45 | 70.5 | 63.5 | 10.16 |

DO NOT SCALE FROM DRAWING



THESE DRAWINGS AND SPECIFICATIONS ARE THE PROPERTY OF NorComp AND SHALL NOT BE REPRODUCED, COPIED OR USED AS THE BASIS FOR THE MANUFACTURE OF SALE OF APPARATUS WITHOUT WRITTEN PERMISSION.

DRAWN: M. SIGMON

DATE: 03-17-11

CHECKED:

DATE:

SCALE: 1 : 1

SHEET 1 OF 1

REV 1

DWG NO.

975TYYY-YYYRYY1

RoHS COMPLIANT

NorComp