

Part Number **ERA.OS.650.CLL**

Size/Series OS / S

[Request a quote](#)**MECHANICAL DETAILS**

Shell Style/Model ERA*: Fixed receptacle, nut fixing

Keying Circular (can rotate), plug has male contact(s)

Housing Material Brass (chrome plated) shell and collet nut, nickel plated brass latch sleeve and mid pieces

Cable Fixing J : 0 - 0 mm

Variant :

	A	B	E	L	L2	M	S1	S3	e
mm.	10	12.4	7	17.5	18.0	1.2	8.2	11	M9x0.6
in.	0.39	0.49	0.28	0.69	0.71	0.05	0.32	0.43	

PERFORMANCE DETAILS

Insert Configuration OS.650 : 1 Triax (50 Ohm)

Insulator L: PEEK

Specifications

Contact Type: Triaxial 50 Ohm (Solder)

Max. Matings: 1000

Contact Dia.: 0.9 mm (0.035" in)

Vtest: 1200 V (AC), 1700 V (DC)

Rated Current: 6 A (AC/DC)

Impedance: 50 Ohm

VSWR: 1.03 + 0.34 * f/GHz

Cable type: RGT 178, RGT 174

OTHER CHARACTERISTICS

Endurance (Shell) 3839 mating cycles

Humidity (max): <=95% [at 60 deg C /140 F]

Vibration: 15 g [10 Hz - 2000 Hz]

Shock Resistance: 100 g [6 ms]

Salt Spray Corrosion: >144 hr

Climatical Category: 50/175/21

Shielding (min): 75 dB (10 MHz)

Shielding (min): 40 dB (1 GHz)

IP Rating 50

Catalog

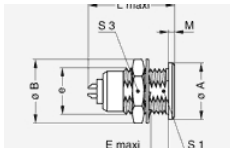
[Copyright](#) [Privacy policy](#) [Product safety](#)