



Part Number

ERA.2S.310.CLL

Size/Series 2S / S

[Request a quote](#)

MECHANICAL DETAILS

Shell Style/Model ERA*: Fixed receptacle, nut fixing
Keying Hermaphroditic keying ("half moon" insert), plug has male pin 1
Housing Material Brass (chrome plated) shell and collet nut, nickel plated brass latch sleeve and mid pieces
Cable Fixing Ø : 0 - 0 mm
Variant :

	A	B	E	L	M	S1	S3	e
mm.	18	19.2	8.5	24.5	1.8	13.5	17	M15x1.0
in.	0.71	0.76	0.33	0.96	0.07	0.53	0.67	

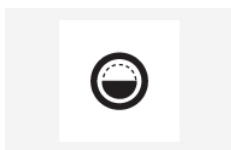
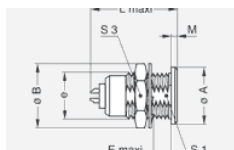

PERFORMANCE DETAILS

Insert Configuration 2S.310 : 10 Low Voltage
Insulator L: PEEK
Vtest: 800 V (AC), 1200 V (DC)
Rated Current: 7 A (AC/DC)

OTHER CHARACTERISTICS

Humidity (max): <=95% [at 60 deg C /140 F]
Vibration: 15 g [10 Hz - 2000 Hz]
Shock Resistance: 100 g [6 ms]
Salt Spray Corrosion: >144 hr
Climatical Category: 50/175/21
Shielding (min): 75 dB (10 MHz)
Shielding (min): 40 dB (1 GHz)
IP Rating 50
Catalog



[Download 3D draw](#)

[Copyright](#) [Privacy policy](#) [Product safety](#)