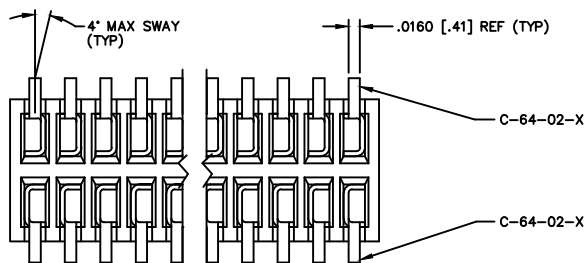
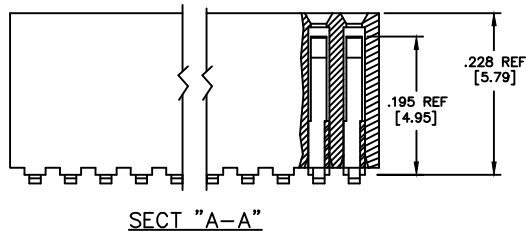
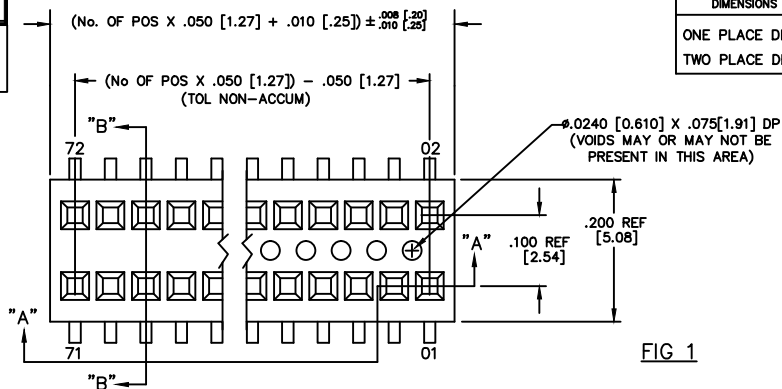

REVISION AS

DO NOT SCALE
FROM THIS PRINT

1. WILL LOSE A POSITION FOR EVERY CUT MADE ON A SOCKET STRIP;
CUT FLASH TO BE .010 [.25] MAX WITH NO FLASH ALLOWED IN HOLES OR EXTENDING BELOW LEADS.
2. \odot REPRESENTS A CRITICAL DIMENSION.
3. MINIMUM RETENTION FORCE: 1.0 LB.
4. DUE TO THE HIGH AMOUNT OF INSERTION FORCE NEEDED, THE -LC OPTION IS NOT COMPATIBLE WITH AUTO PLACEMENT. SAMTEC RECOMMENDS MANUAL PLACEMENT FOR ALL ASSEMBLIES WITH THE -LC OPTION.
5. INSULATOR MATERIAL: LCP, UL 94 VO

UNLESS OTHERWISE NOTED

DIMENSIONS ARE IN INCHES

TOLERANCES ARE:

ONE PLACE DECIMALS: $\pm .1$ THREE PLACE DECIMALS: $\pm .005$ TWO PLACE DECIMALS: $\pm .01$ FOUR PLACE DECIMALS: $\pm .0020$

ANGLES

 $\pm 5^\circ$

TITLE:

RECEPTACLE
SURFACE MOUNT
(DOUBLE ROW)

DWG NO:

RSM-1XX-XX-XXX-D-XX
SHEET 1 OF 2

RSM-1XX-XX-XXX-D-XX

BODY LENGTH SPECIFICATION
-02 THRU -40 POSITIONS

LEAD STYLE
-02: C-64-02-X

PLATING SPECIFICATIONS

- S: 30μ" SELECTIVE GOLD IN CONTACT AREA
MATTE TIN ON TAIL
- F: 3 FLASH SELECTIVE GOLD IN CONTACT AREA
MATTE TIN ON TAIL
- L: 10μ" LIGHT SELECTIVE GOLD IN CONTACT AREA
MATTE TIN ON TAIL
- T: MATTE TIN CONTACT AND TAIL
- STL: 30μ" SELECTIVE GOLD IN CONTACT AREA
TIN/LEAD (90%/10 +/ -5%) TAIL
- H: 30μ" HEAVY GOLD IN CONTACT AREA
3 ON TAIL
- TM: MATTE TIN CONTACT AND TAIL
- SM: 30μ" SELECTIVE GOLD IN CONTACT AREA
MATTE TIN ON TAIL
- LM: 10μ" LIGHT SELECTIVE GOLD IN CONTACT AREA
MATTE TIN ON TAIL
- FM: 3μ" FLASH SELECTIVE GOLD IN CONTACT AREA
MATTE TIN ON TAIL

OPTIONS

- LC: LOCKING CLIP
(USE LC-05-TM)(SEE FIG 2, SHT 2)(SEE NOTE 4)
- P: PICK AND PLACE PAD
(AVAILABLE ON POS. 5 THRU 40 ONLY)
(USE LMP-02)(SEE FIG 3, SHT 2)
- K: POLYAMIDE FILM PAD
(AVAILABLE ON POS. 5 THRU 40 ONLY)
(.005 [.13] THICKNESS WITH SILICONE
ADHESIVE)(SEE FIG 4, SHT 2)
(USE K-500-300)
- TR: TAPE & REEL

BODY SPECIFICATION

- D: DOUBLE ROW
(USE RSM-XX-D)

CRITICAL DIMENSION INSPECTION TABLE

ASSEMBLY OPERATION	IN-PROCESS INSPECTION
BREAK CARRIER	C1
ROTARY CUT	C2

NOTE:

1. CONTACTS CAN BE INTERLEAVED

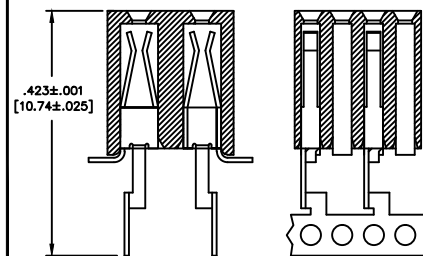

PACKAGING

NOTES:

1. 1st POSITION TO BE LOADED IN TUBE IN THE DIRECTION OF THE ARROW.
2. LAYER PACKAGE POSITIONS 2-4, TUBE PACKAGE POSITIONS 5-36
3. ENDWALLS TO BE .020 ± .003"

TABLE 1

OPTION	TUBE	PLUG
-K, -LC, -K-LC	PT-1-24-04-64	TP-03
NONE, -P, -P-LC	PT-1-24-05-38	TP-09

EXISPROD\ASSEMBLY\050
RSM-DASM

samtec

520 PARK EAST BLVD. NEW ALBANY, INDIANA 47150
PHONE (812) 944-6733 P.O. BOX 1147
CODE 55322

MADE BY:

GREG REIDINGER 11-24-92

RSM-1XX-XX-XXX-D-XX
SHEET 1 OF 2

PROPRIETARY NOTE

THIS DOCUMENT CONTAINS INFORMATION
CONFIDENTIAL AND PROPRIETARY TO
SAMTEC INC. AND SHALL NOT BE
REPRODUCED OR TRANSFERRED TO
OTHER DOCUMENTS OR DISCLOSED TO
OTHERS OR USED FOR ANY PURPOSE
OTHER THAN THAT FOR WHICH IT WAS
OBTAINED WITHOUT THE EXPRESSED
WRITTEN CONSENT OF SAMTEC INC.

PT-1-24-05-38

PT-1-24-04-64