

ITEM	QTY	PART NUMBER	DESCRIPTION
1	1	F040006	D16EER11
2	1	F050416	50-004-16 6VDC GREEN LED
3	1	F050102	50-001-02 CONCAVE GREEN B

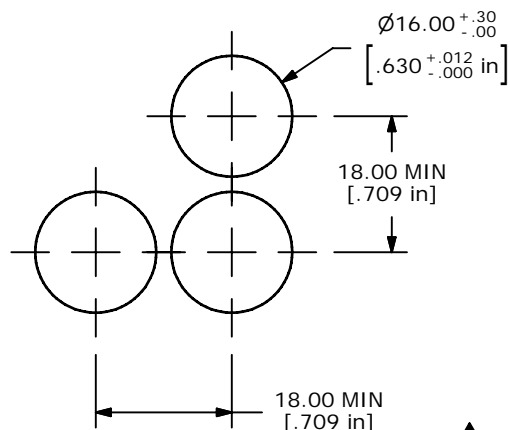

PANEL MOUNTING

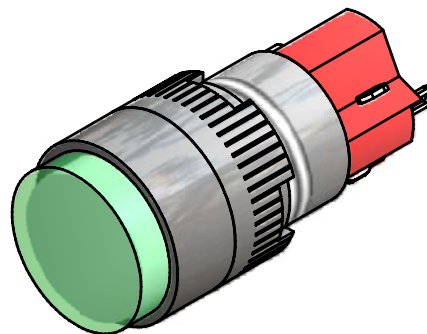
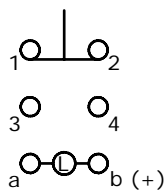

CONTACT CONFIGURATION

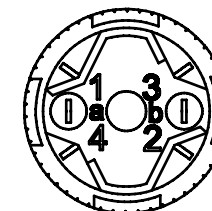
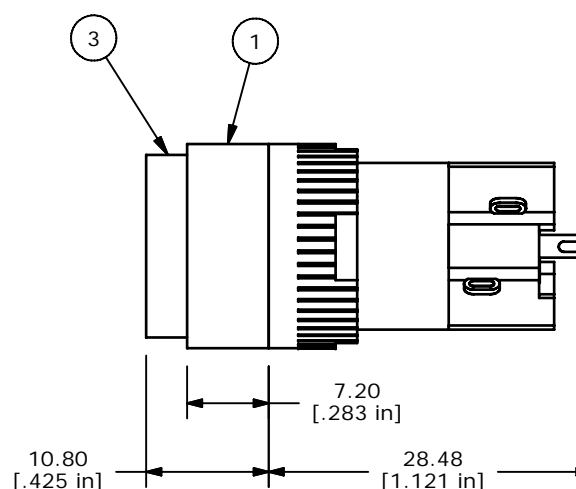
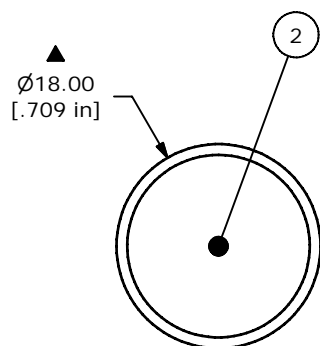

NOTE:

1. ALL DIMENSIONS IN MM [INCH]
2. GENERAL TOLERANCE: X.X=±0.4
X.XX=±0.25
3. TERMINAL NUMBERS FOR REF ONLY
4. MECHANICAL LIFE: 2,000,000 OPERATIONS
5. INSULATION RESISTANCE: 1,000 MILLI-OHM MIN.
6. OPERATING TEMP.: -25°C to 55°C
- ▲ 7. LED VOLTAGE: 6VDC GREEN
8. ▲ DENOTES CRITICAL PARAMETER.

B	18029	Parts description was 50-001-06	3/19/08	rc
A	14453	RELEASED FOR PRODUCTION	11/3/04	AR
REV	PCR NO	DESCRIPTION	DATE	BY

THE INFORMATION CONTAINED IN THIS DOCUMENT IS PROPRIETARY
TO E-SWITCH AND IS NOT TO BE COPIED OR TRANSFERRED

E-SWITCH®

TITLE D16EER11HGRNGRN

SCALE 2:1

DATE 11/3/2004

DR AR

DWG XF0611A

REV B