

- NOTES: 1. MEASURED AT THE BOTTOM
 2. MATERIAL : PBT 30% GLASSFILLED
 3. THE 'LF' PRODUCT MEETS EUROPEAN UNION DIRECTIVES AND OTHER COUNTRY REGULATIONS AS DESCRIBED IN GS-22-008
 4. PARTS WITH AND WITHOUT SUFFIX LF TO THE PRODUCT PART NUMBER ARE IDENTICAL IN FORM, FIT AND FUNCTION. LF SUFFIX IS ADDED TO THE PART NUMBER OF THIS PRODUCT TO HAVE UNIFORM IDENTIFICATION OF ALL RoHS COMPATIBLE PRODUCTS

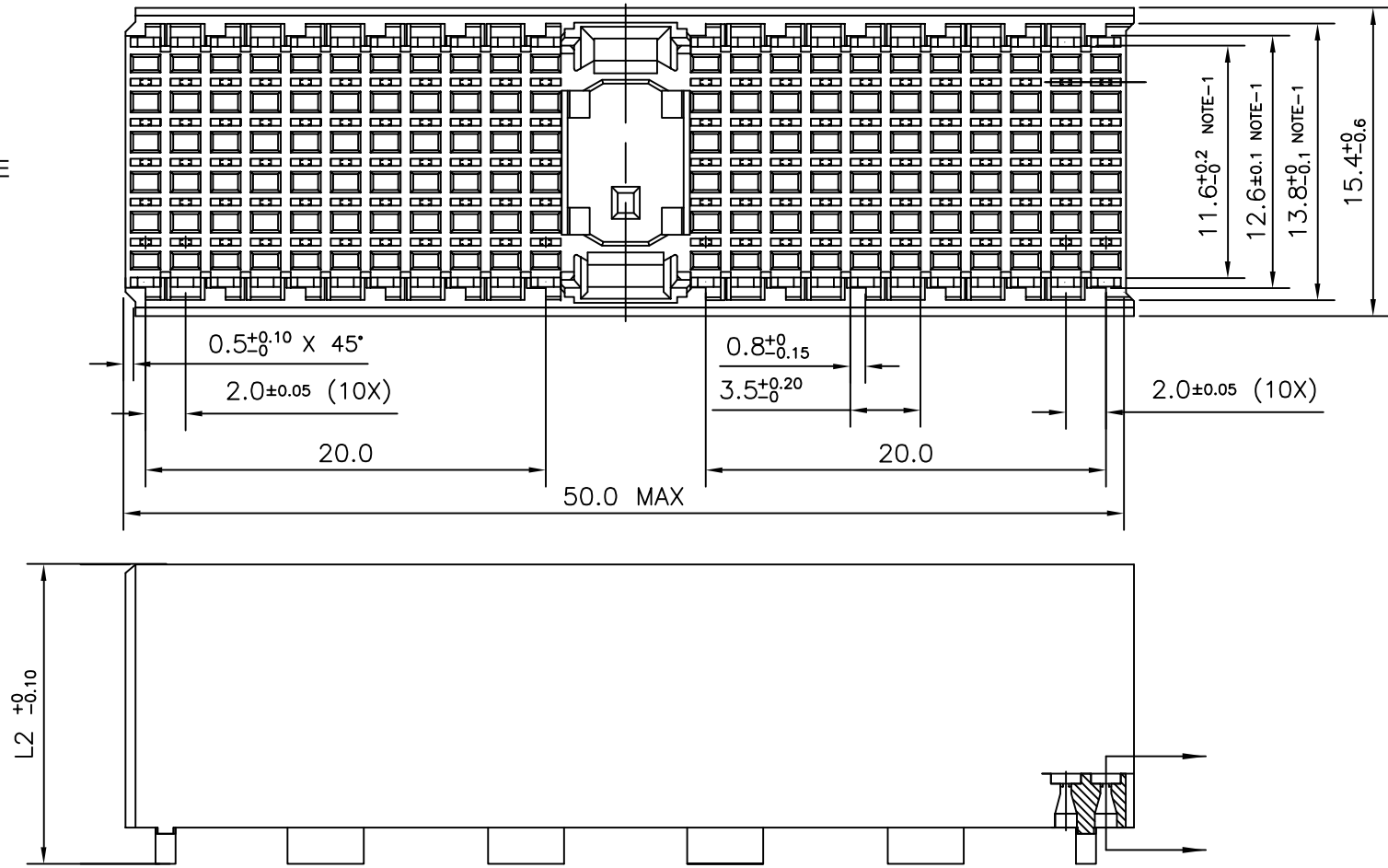

PART NO: HM2HN1P2-**LF**
 RoHS COMPATIBLE (DIGIT 11 & 12)
 STANDOFF HEIGHT INDICATOR

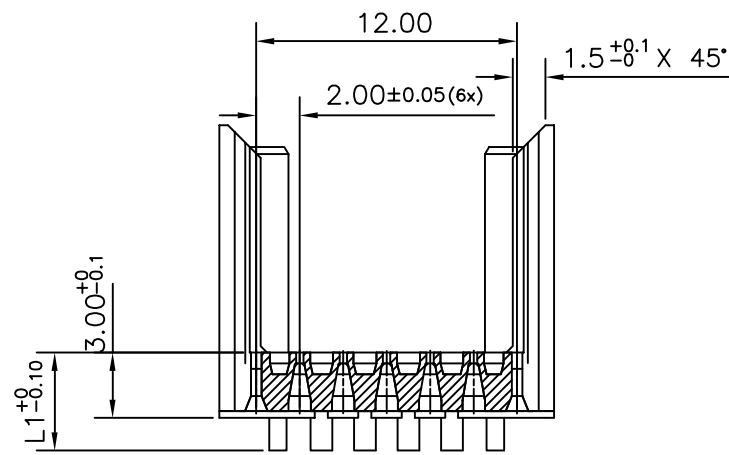
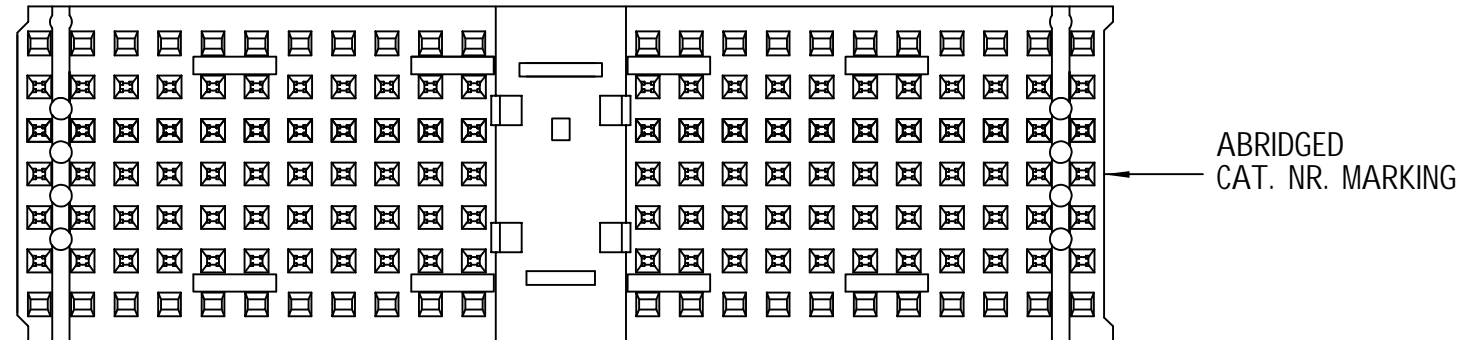

PART NUMBER	L1	L2	
HM2HN1P2LF	3.0	13.45	AVAILABLE
HM2HN1P209LF	3.9	14.35	AVAILABLE
HM2HN1P211LF	4.1	14.55	NOT YET AVAILABLE
HM2HN1P213LF	4.3	14.75	NOT YET AVAILABLE
HM2HN1P215LF	4.5	14.95	AVAILABLE
HM2HN1P217LF	4.7	15.15	AVAILABLE
HM2HN1P219LF	4.9	15.35	AVAILABLE
HM2HN1P222LF	5.2	15.65	AVAILABLE
HM2HN1P230LF	6.0	16.45	AVAILABLE

mat'l. code SEE NOTE 2				surface ISO 1302 ✓	tolerance ISO 406 ISO 1101	projection MM	product family MILLIPACS
ltr	ecn no	dr	date	tolerances unless otherwise specified		MM	title MILLIPACS SHROUD TYPE - A (WIDTH = 15.4 MAX)
A	105-0139	MINI	2005-08-10	angles	linear		
B	106-0099	MINI	2006-07-08	0°±1°			
C	107-0107	MINI	2007-08-31			scale -	
				dr	MINI K VANDANATH	2005-03-08	dwg no sheet 1 of 1 size A3
				enr	BIJU K PAUL	2005-03-08	
				chr	BIJU K PAUL	2007-08-31	
				appd	BIJU K PAUL	2007-08-31	
sheet index	revision sheet	C	1				type Product Customer Drawing